

SYMBOL LEGEND	LINE LEGEND
	—OP— EXISTING OVERHEAD POWER
	—#— EXISTING WATER LINE
	—S— EXISTING SEWER LINE
	—DW— PROPOSED DOMESTIC WATER
	—77— PROPOSED FIRE PROTECTION
	—W— PROPOSED WATER SUPPLY LINE
	—SS— PROPOSED SEWER LINE
	—UC— PROPOSED UNDERGROUND POWER
	—G— PROPOSED UNDERGROUND GAS
	—CD— PROPOSED SCH 80 CONDUIT
	—CITY— PROPOSED CABLE TV SERVICE
	—72— PROPOSED TELEPHONE SERVICE
	—345— EXISTING CONTOUR LINE
	—345— PROPOSED CONTOUR LINE
	—--- BUILDING SETBACK LINE

**SITE DEMOLITION PLAN NOTES:**

DEMOLITION CONTRACTOR SHALL CONTACT MISSISSIPPI ONE CALL SYSTEM (601 362-4374 OR TOLL FREE 1 800 227-6477) TO LOCATE AND MARK ALL UNDERGROUND UTILITIES BEFORE ANY EXCAVATION IS PERFORMED ON SITE.

ALL ITEMS NOTED FOR REMOVAL AND DISPOSAL SHALL BE HAULED OFF SITE AND PROPERLY DISPOSED OFF SITE BY CONTRACTOR.

THE CONSTRUCTION EXIT SHALL BE MAINTAINED SUCH THAT ALL MATERIALS SPILLED, DROPPED WASHED OR TRACKED FROM VEHICLES OR SITE ONTO ROADWAYS MUST BE REMOVED IMMEDIATELY.

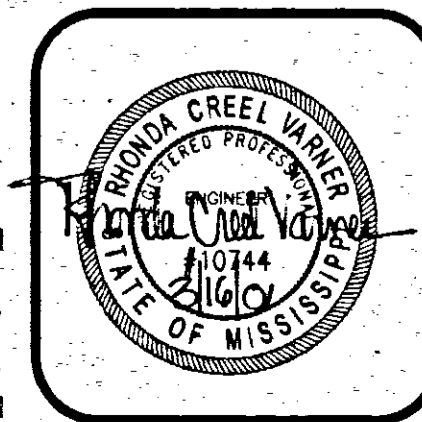
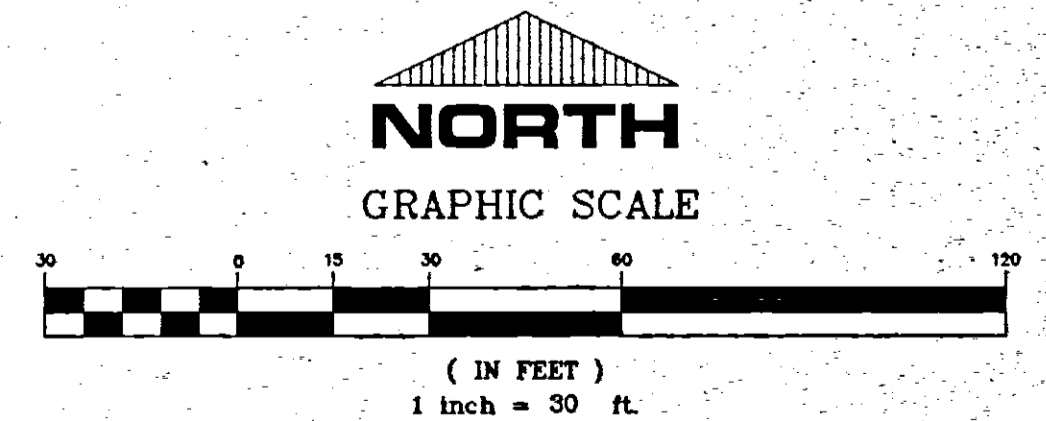

**STERLING**  
Consultants

<b>SITE DEMOLITION PLAN</b>	
<b>DRURY INN &amp; SUITES</b>	
RIDGELAND, MISSISSIPPI	
DRUCO, INC. ST. LOUIS, MO.	
DWG BY: R.O.B.	REVISIONS:
DATE: 03-16-01	SHEET NO. <b>D-1</b>



C:\Drawings\DRURY\133181.dwg Fri Mar 16 11:54:46 2001 R. David Bates - Sterling Consultants, Inc.



SYMBOL LEGEND		LINE LEGEND	
	HANDICAP SPACE		EXISTING OVERHEAD POWER
	POWER POLE		EXISTING WATER LINE
	LIGHT POLE		EXISTING SEWER LINE
	EXISTING FIRE HYDRANT		PROPOSED DOMESTIC WATER
	EXISTING SEWER MANHOLE		PROPOSED FIRE PROTECTION
	PROPOSED INLET		PROPOSED WATER SUPPLY LINE
	EXISTING GATE VALVE		PROPOSED SEWER LINE
	PROPOSED WATER METER		PROPOSED UNDERGROUND POWER
	PROPOSED TEE		PROPOSED UNDERGROUND GAS
	PROPOSED FIRE HYDRANT		PROPOSED SCH 80 CONDUIT
	PROPOSED GREASE TRAP		PROPOSED CABLE TV SERVICE
	PROPOSED TRANSFORMER		PROPOSED TELEPHONE SERVICE
	PROPOSED GENERATOR		EXISTING CONTOUR LINE
	PROPOSED WALL PACK		PROPOSED CONTOUR LINE
	PROPOSED STREET LIGHT		BUILDING SETBACK LINE
	PROPOSED SEWER MANHOLE		
	PROPOSED GAS METER		
	BACK FLOW PREVENTOR		

PAVEMENT LEGEND	
	SIGN
	FIRE HYDRANT
	WATER VALVE
	FENCE
	FOUND IRON PIN
	FOUND CONC. MONUMENT
	SOIL BORING LOCATION
	HEAVY DUTY BITUMINOUS PAVEMENT
	LIGHT DUTY BITUMINOUS PAVEMENT
	HEAVY DUTY CONCRETE PAVEMENT
	COURSE AGGREGATE SLAG STAGING AREA

**SITE LAYOUT PLAN NOTES:**

- TOTAL AREA OF SITE : 4.69 ACRES
- BOUNDARY AND TOPOGRAPHIC INFORMATION TAKEN FROM PLAT OF SURVEY BY: STERLING CONSULTANTS, INC. 860 EAST RIVER PLACE SUITE 205 JACKSON, MS 39202
- PARKING SUMMARY:  
203 PARKING SPACES FOR CARS  
6 HANDICAP PARKING SPACES  
209 TOTAL PARKING SPACES
- ALL CONSTRUCTION SHALL BE IN ACCORDANCE WITH THE CITY OF RIDGELAND STANDARD SPECIFICATIONS FOR STREETS, PAVEMENTS, SEWER AND WATER DISTRIBUTION SYSTEMS.
- GENERAL CONTRACTOR SHALL NOTIFY THE CITY OF RIDGELAND PUBLIC WORKS DEPARTMENT AT LEAST 24 HOURS PRIOR TO ANY CONNECTION INTO CITY UTILITIES AND STREET.
- GENERAL CONTRACTOR SHALL CONTACT MISSISSIPPI ONE CALL SYSTEM (601) 362-4374, TO LOCATE AND MARK ALL UNDERGROUND UTILITIES BEFORE ANY EXCAVATION IS PERFORMED ON SITE.
- CONTRACTOR SHALL INSTALL CONDUIT UNDER EACH DRIVEWAY FOR IRRIGATION SYSTEM AND IN OTHER LOCATIONS AS DIRECTED BY OWNER. MINIMUM DEPTH OF COVER SHALL BE 42". CONTRACTOR SHALL COORDINATE INSTALLATION OF CONDUIT FOR OTHER UTILITIES AS SHOWN ON THE OTHER SITE PLANS.
- CONTACTS FOR SERVING UTILITIES:  
ELECTRICAL SERVICE: ENTERGY  
CONTACT PERSON : TIM GOLDEN  
PHONE: (601) 351-4110  
GAS SERVICE: MISSISSIPPI VALLEY GAS CO.  
CONTACT PERSON : NEAL WASHBURN  
PHONE: (601) 961-6823  
WATER SERVICE: CITY OF RIDGELAND  
CONTACT PERSON: BEN MAYS  
PHONE: (601) 856-3877  
SANITARY SEWER CITY OF RIDGELAND  
CONTACT PERSON: BEN MAYS  
PHONE: (601) 856-3877  
TELEPHONE SERVICE: BELL SOUTH  
CONTACT PERSON: ROBERT DERRICK  
PHONE: (601) 939-0694  
TELEVISION/CABLE SERVICE: TIME WARNER  
CONTACT PERSON: WALET WHITEHEAD  
PHONE: (601) 982-0822
- REFER TO PLUMBING AND ELECTRICAL PLANS FOR EXACT LOCATION OF THE-INS FOR BUILDING SERVICES.
- IN CASE OF CONFLICT BETWEEN THIS DRAWING AND/OR THE SPECIFICATIONS, THE ENGINEER SHALL BE IMMEDIATELY NOTIFIED FOR CLARIFICATION.
- REFER TO SITE DETAIL PLANS FOR DIMENSIONS AND CONSTRUCTION REQUIREMENTS FOR SIDEWALKS, RAMPS AND HANDICAP ACCESS FEATURES.
- THE CONCRETE SERVICE DRIVE SHALL BE CONSTRUCTED IN STRICT ACCORDANCE WITH THE LATEST AASHTO AND ASTM STANDARDS, INCLUDING THICKENED EXTERIOR EDGES AND CORNERS, LOAD TRANSFER DEVICES AND JOINT SEAWANT. PAVEMENT SLABS SHALL BE NO LARGER THAN 15 FEET SQUARE. CONTRACTOR SHALL SUBMIT PROPOSED JOINT LAYOUT FOR APPROVAL BY ENGINEER PRIOR TO CONSTRUCTION.
- STREET SUB GRADE AREAS WHERE EXPANSIVE CLAYS (CH) ARE ENCOUNTERED WITHIN 4" OF FINISHED GRADE SHALL BE UNDERCUT AND BACK FILLED AS REQUIRED TO SEPARATE PAVEMENT FROM EXPANSIVE CLAYS BY A MINIMUM 3 FOOT THICK LAYER OF SELECT SILTY CLAYS(CS) OR SANDY CLAYS (SC) HAVING A LIQUID LIMIT OF LESS THAN 40 AND A PI WITHIN THE RANGE OF 8 TO 20. THE BACK FILL AND FILL MATERIALS SHOULD BE SPREAD IN LOOSE LIFTS HAVING A MAXIMUM THICKNESS OF 9 IN. AND COMPACTED TO NOT LESS THAN 95 PERCENT OF STANDARD PROCTOR MAXIMUM DRY DENSITY (ASTM D 690) AT MOISTURE CONTENTS WITHIN 3 PERCENTAGE POINTS OF THE OPTIMUM MOISTURE CONTENT. STABILITY MUST BE EVIDENT DURING COMPACTION OF EACH LIFT BEFORE ANY SUBSEQUENT LIFTS OF FILL OR BACK FILL MATERIAL ARE ADDED.
- UNDERCUTTING AND BACK FILLING SHALL EXTEND A MINIMUM OF 2 FEET BEYOND BACK OF CURB.
- PRIOR TO PLACING ASPHALT BASE MATERIAL, PAVING CONTRACTOR SHALL 1) FINE-GRADE THE SUB GRADE MATERIAL TO THE PROPER SECTION TO PERMIT PLACEMENT OF THE REQUIRED THICKNESS OF BASE COURSE; 2) COMPACT AND PROOF-ROLL SUB GRADE TO ACHIEVE STABILITY; AND ENSURE REQUIRED SUB GRADE DENSITY HAS BEEN ACHIEVED AND VERIFIED BY SOILS TESTING LABORATORY.
- AFTER FORMS AND/OR CURB AND GUTTER STRING LINES HAVE BEEN SET AND BEFORE CONCRETE IS POURED, CONTRACTOR SHALL VERIFY THAT ALL GUTTERS DRAIN TO INLETS. MINIMUM SLOPE: 9" PER 100'
- EXPANSION JOINTS IN CURB AND GUTTER SHALL BE 1/2" JOINT MATERIAL PLACED AT 30' (MAXIMUM) INTERVALS.
- CONTRACTION JOINTS IN CURB AND GUTTER SHALL BE SCORED AT INTERVALS NOT GREATER THAN 10 FEET AND SPACED EQUALLY BETWEEN EXPANSION JOINTS.
- CONCRETE FOR CURB AND GUTTER SHALL BE 3,000 PSI MINIMUM.

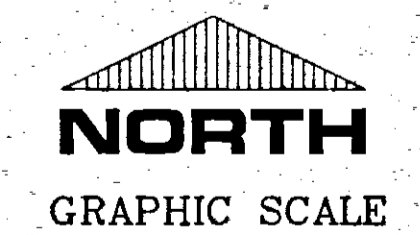

( IN FEET )  
1 inch = 30 ft.



**STERLING**  
Consultants  
ENGINEERS ARCHITECTS

<b>SITE LAYOUT PLAN</b>	
<b>DRURY INN &amp; SUITES</b>	
RIDGELAND, MISSISSIPPI	
DRUCO, INC. ST. LOUIS, MO.	
DWG BY: R.D.B.	REVISIONS:
DATE: 03-16-01	SHEET NO. <b>C-1</b>

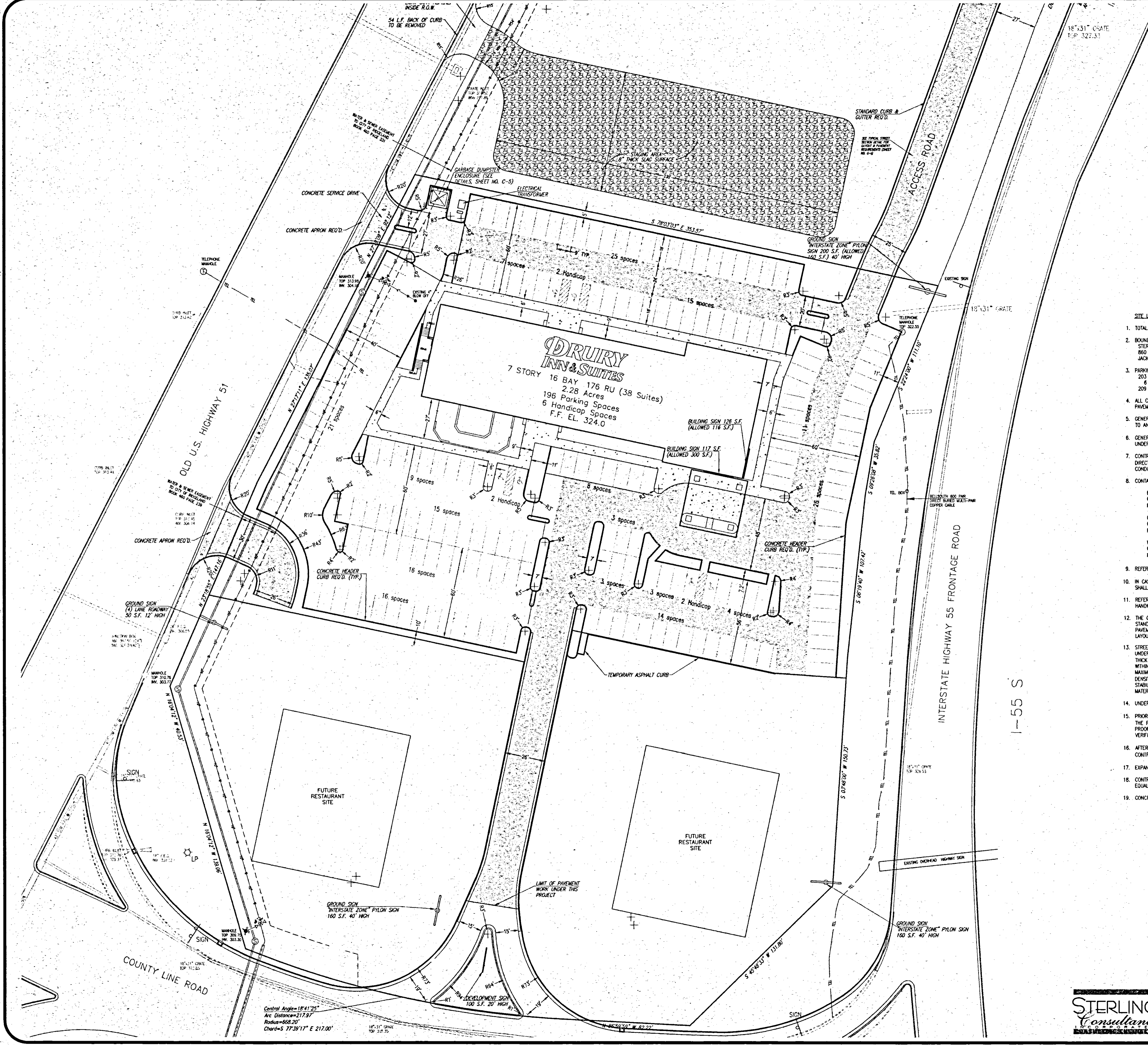

C:\Drawings\DRURY\val\Site.dwg Fri Mar 16 11:55:36 2001 R. David Bates - Sterling Consultants, Inc.







SYMBOL LEGEND	LINE LEGEND
	—DP— EXISTING OVERHEAD POWER
	—W— EXISTING WATER LINE
	—S— EXISTING SEWER LINE
	—DW— PROPOSED DOMESTIC WATER
	—FP— PROPOSED FIRE PROTECTION
	—W— PROPOSED WATER SUPPLY LINE
	—CS— PROPOSED SEWER LINE
	—C— PROPOSED UNDERGROUND GAS
	—C— PROPOSED SCH 80 CONDUIT
	—C— PROPOSED CABLE TV SERVICE
	—TEL— PROPOSED TELEPHONE SERVICE
	—G— EXISTING CONTOUR LINE
	—G— PROPOSED CONTOUR LINE
	—G— PROPOSED CONTOUR LINE
	—G— PROPOSED CONTOUR LINE
	—G— PROPOSED CONTOUR LINE
	—G— PROPOSED CONTOUR LINE
	—G— PROPOSED CONTOUR LINE
	—G— PROPOSED CONTOUR LINE
	—G— PROPOSED CONTOUR LINE
	—G— PROPOSED CONTOUR LINE
	—G— PROPOSED CONTOUR LINE
	—G— PROPOSED CONTOUR LINE
	—G— PROPOSED CONTOUR LINE
	—G— PROPOSED CONTOUR LINE
	—G— PROPOSED CONTOUR LINE

**GRADING AND DRAINAGE NOTES**

1. GRADING CONTRACTOR SHALL CONTACT MISSISSIPPI ONE CALL SYSTEM (601-362-4374 OR TOLL FREE 1-800-227-6477) TO LOCATED AND MARK ALL UNDERGROUND UTILITIES BEFORE ANY EXCAVATION IS PERFORMED ON SITE.
2. SUB GRADE BENEATH CURB AND GUTTER SHALL BE FINE GRADED AND COMPACTED TO ACHIEVE STABILITY UNDER PRESSURE OF THE REAR WHEEL LOADING OF A MOTOR GRADER MOVING SLOWLY OVER THE CURB AND GUTTER SUB GRADE.
3. ALL STORM DRAINAGE PIPE AND INLETS SHALL BE FLUSHED AND CLEARED OF ANY CONSTRUCTION MATERIALS AND/OR SEDIMENT UPON PROJECT COMPLETION.
4. THE CONSTRUCTION EXIT SHALL BE MAINTAINED SUCH THAT ALL MATERIALS SPILLED, DROPPED, WASHED OR TRACKED FROM VEHICLES OR SITE ONTO ROADWAYS MUST BE REMOVED IMMEDIATELY.
5. INLET SEDIMENT TRAPS ARE REQUIRED AT EACH INLET AND SHALL CONSIST OF HAY BALES FULLY SURROUNDING EACH INLET.
6. SEDIMENT BARRIERS SHALL BE HAY BALES PLACED IN ALL DRAINAGE WAYS TO PREVENT SEDIMENT FROM LEAVING CONSTRUCTION SITE.
7. CONTRACTOR RESPONSIBLE FOR STORM PIPE INSTALLATION SHALL VERIFY CONSTRUCTION STAKING ON ALL PIPE BEFORE ANY PIPE IS INSTALLED TO ENSURE PROPER DRAINAGE. ANY DISCREPANCIES SHALL BE DISCUSSED WITH ENGINEER BEFORE PIPES ARE INSTALLED.

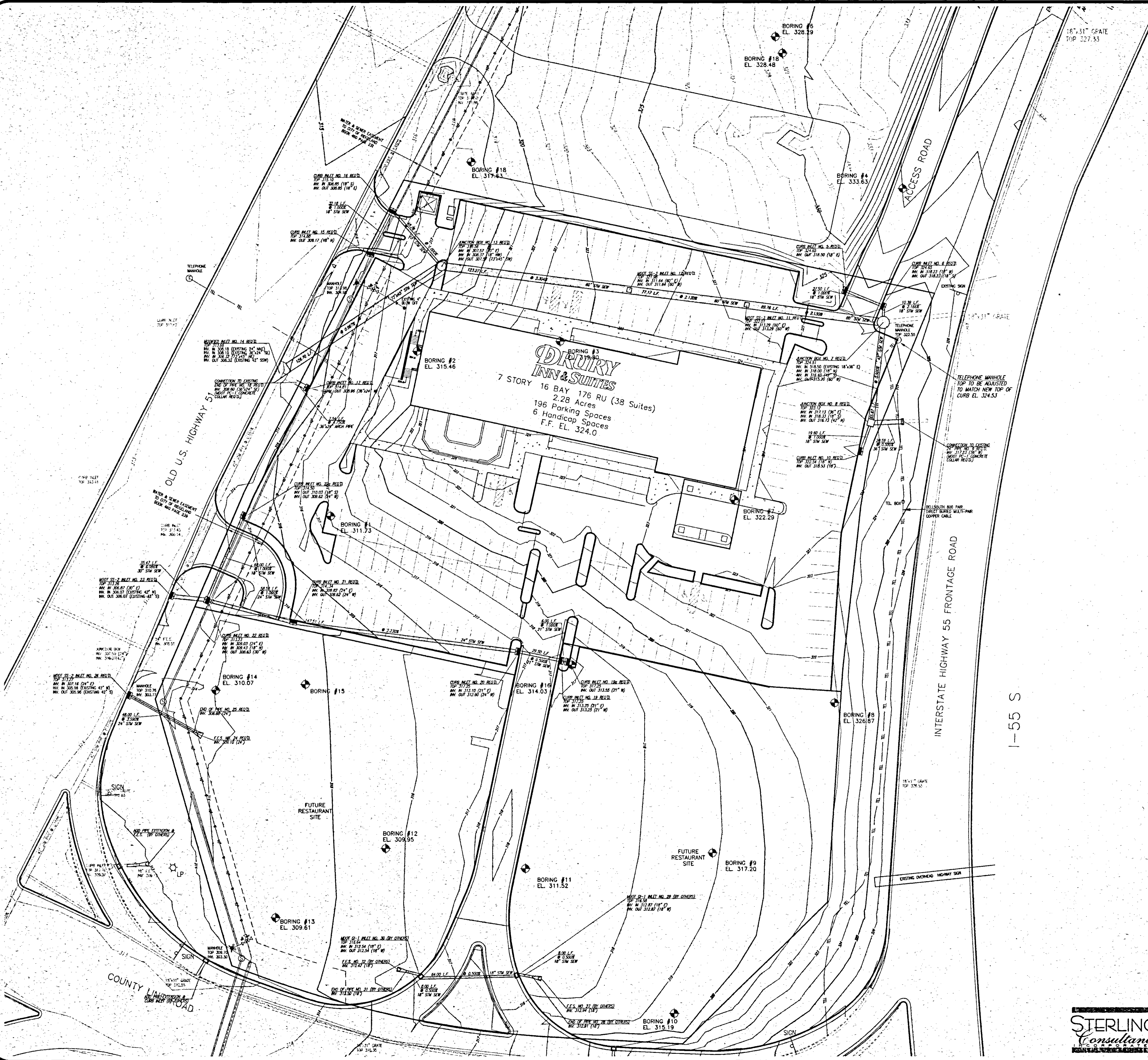
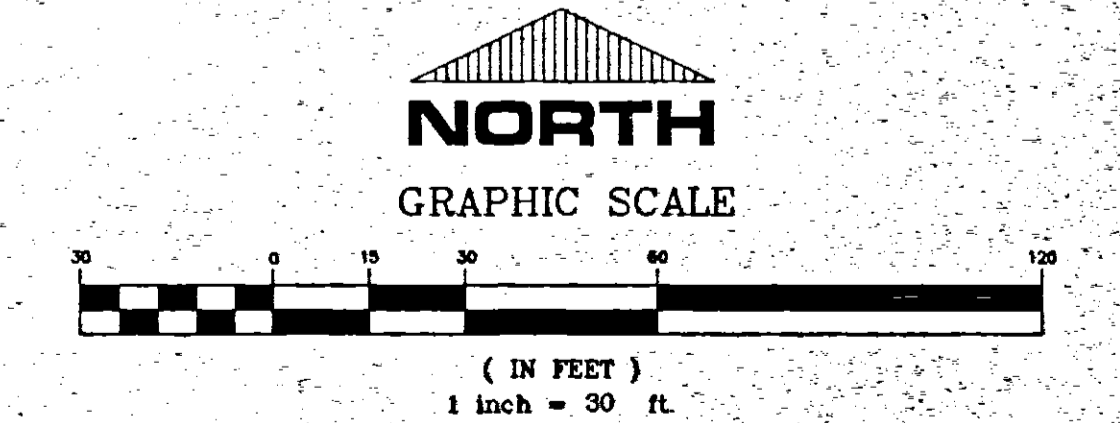

**STERLING**  
Consultants  
CORPORATION

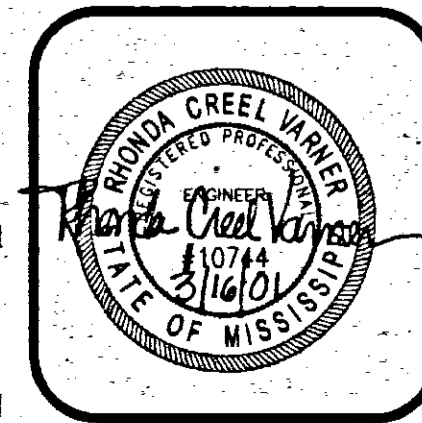

<b>SITE GRADING &amp; DRAINAGE PLAN</b>	
<b>DRURY INN &amp; SUITES</b>	<b>DRUCO, INC.</b>
RIDGELAND, MISSISSIPPI	ST. LOUIS, MO.
DWG BY: R.D.B.	REVISIONS:
DATE: 03-16-01	SHEET NO.
	<b>C-3</b>

C:\Drawings\DRURY\altissie.dwg Fri Mar 16 11:56:27 2001 R. David Bates - Sterling Consultants, Inc.



SYMBOL LEGEND	LINE LEGEND
	—OP— EXISTING OVERHEAD POWER
	—E— EXISTING WATER LINE
	—S— EXISTING SEWER LINE
	—DP— PROPOSED DOMESTIC WATER
	—FP— PROPOSED FIRE PROTECTION
	—W— PROPOSED WATER SUPPLY LINE
	—SS— PROPOSED SEWER LINE
	—UC— PROPOSED UNDERGROUND POWER
	—G— PROPOSED UNDERGROUND GAS
	—CD— PROPOSED SCH 80 CONDUIT
	—CITY— PROPOSED CABLE TV SERVICE
	—TEL— PROPOSED TELEPHONE SERVICE
	—45— EXISTING CONTOUR LINE
	—345— PROPOSED CONTOUR LINE
	—B— BUILDING SETBACK LINE

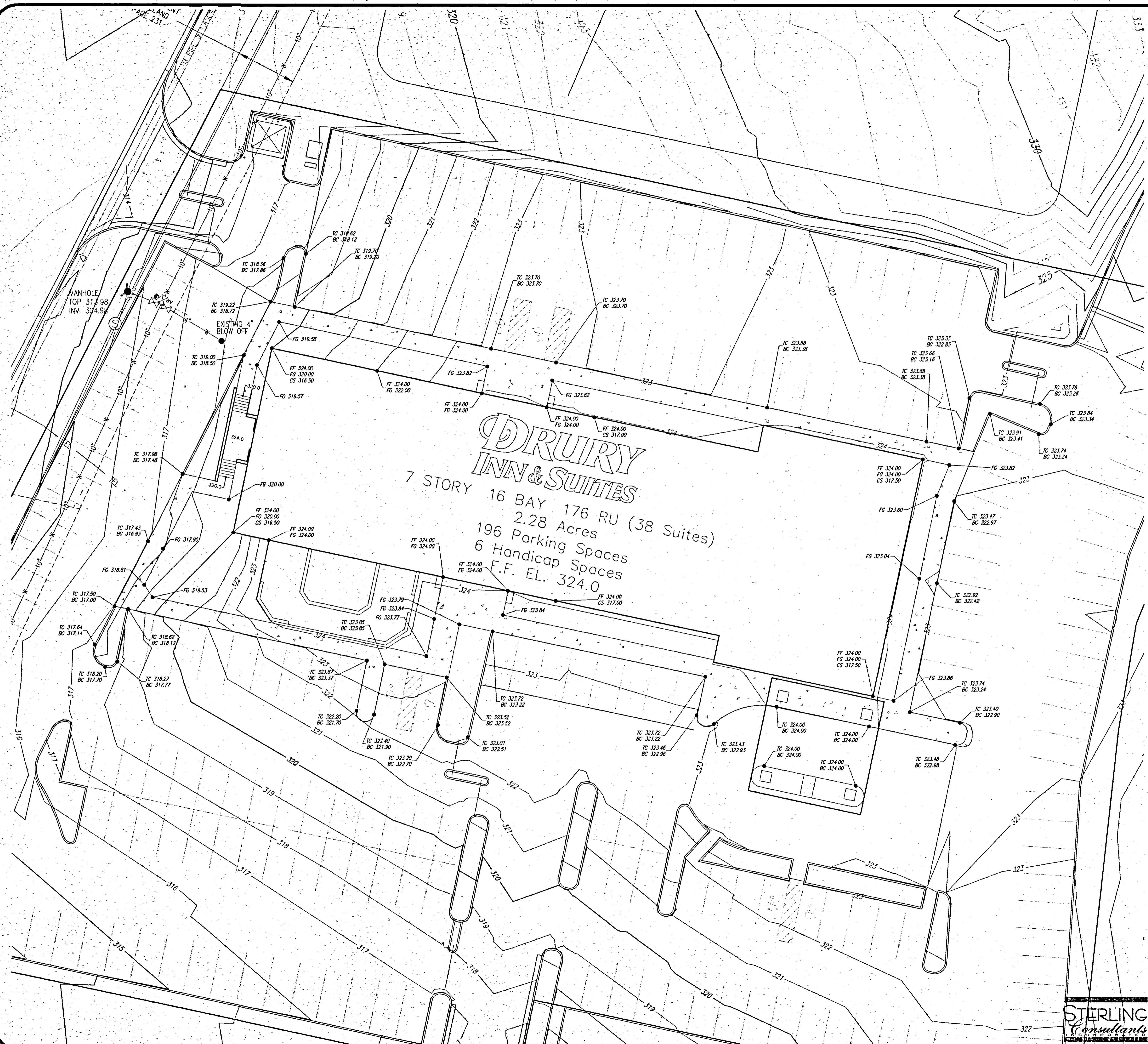

**DRURY INN & SUITES**  
 7 STORY 16 BAY 176 RU (38 Suites)  
 2.28 Acres  
 196 Parking Spaces  
 6 Handicap Spaces  
 F.F. EL. 324.0

**NORTH**  
 GRAPHIC SCALE

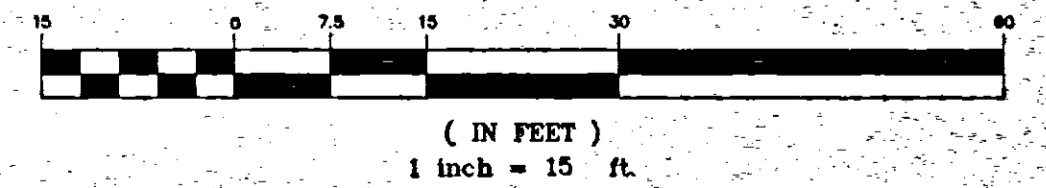

<b>BUILDING AREA GRADING PLAN</b>	
<b>DRURY INN &amp; SUITES</b>	<b>DRUCO, INC.</b>
RIDGELAND, MISSISSIPPI	ST. LOUIS, MO.
DWG BY: R.D.B.	REVISIONS:
DATE: 03-16-01	SHEET NO. <b>C-4</b>

C:\Drawings\DRURY\alt\site.dwg - Fr, Mar 16 11:57:00 2001 R. David Bates - Sterling Consultants, Inc.



CURVE TABLE		
STATION	RADIUS	ANGLE
0+00	1000.00	90.00°
0+40	1000.00	90.00°
0+80	1000.00	90.00°
1+20	1000.00	90.00°
1+60	1000.00	90.00°
2+00	1000.00	90.00°
2+40	1000.00	90.00°
2+80	1000.00	90.00°
3+20	1000.00	90.00°
3+60	1000.00	90.00°

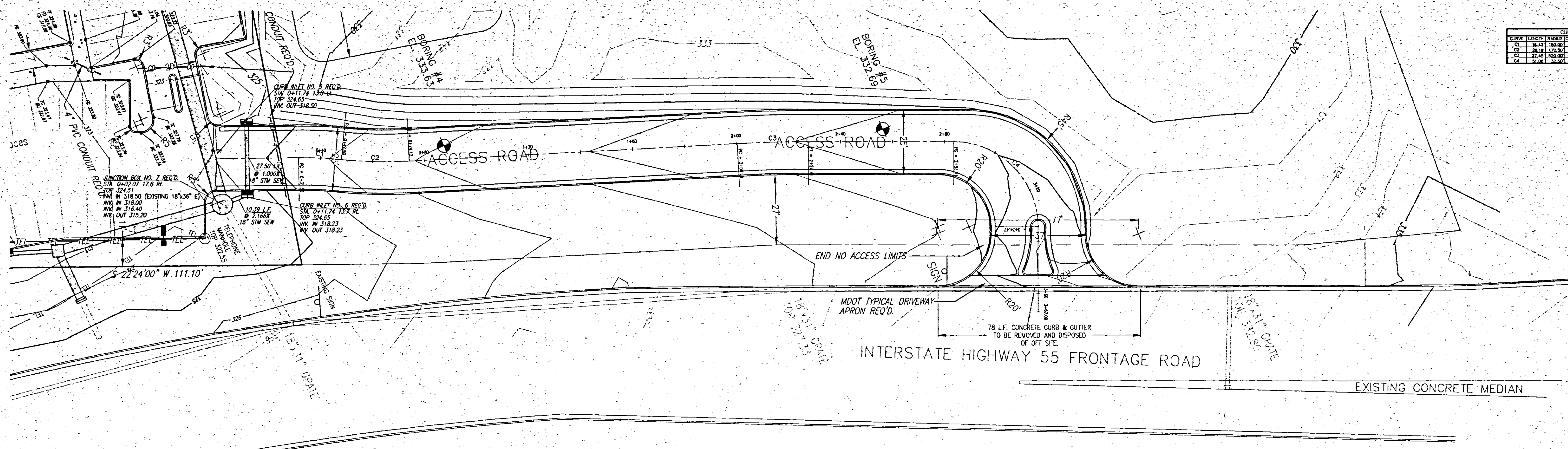

SCALE 1"=20' HORIZ.  
1"=5' VERT.

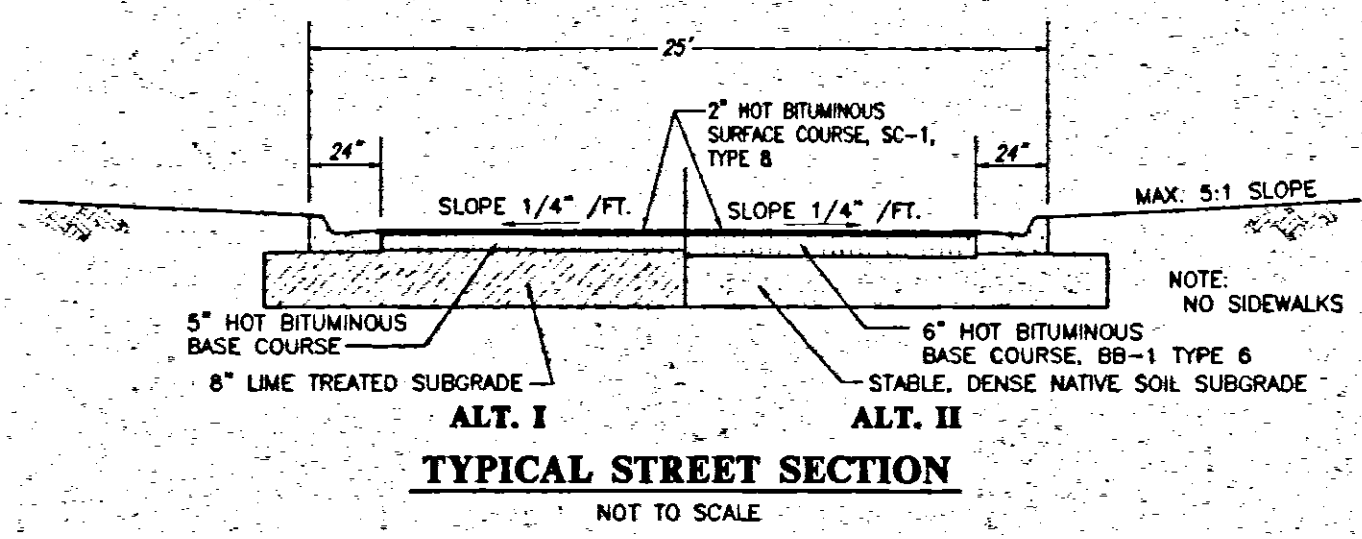
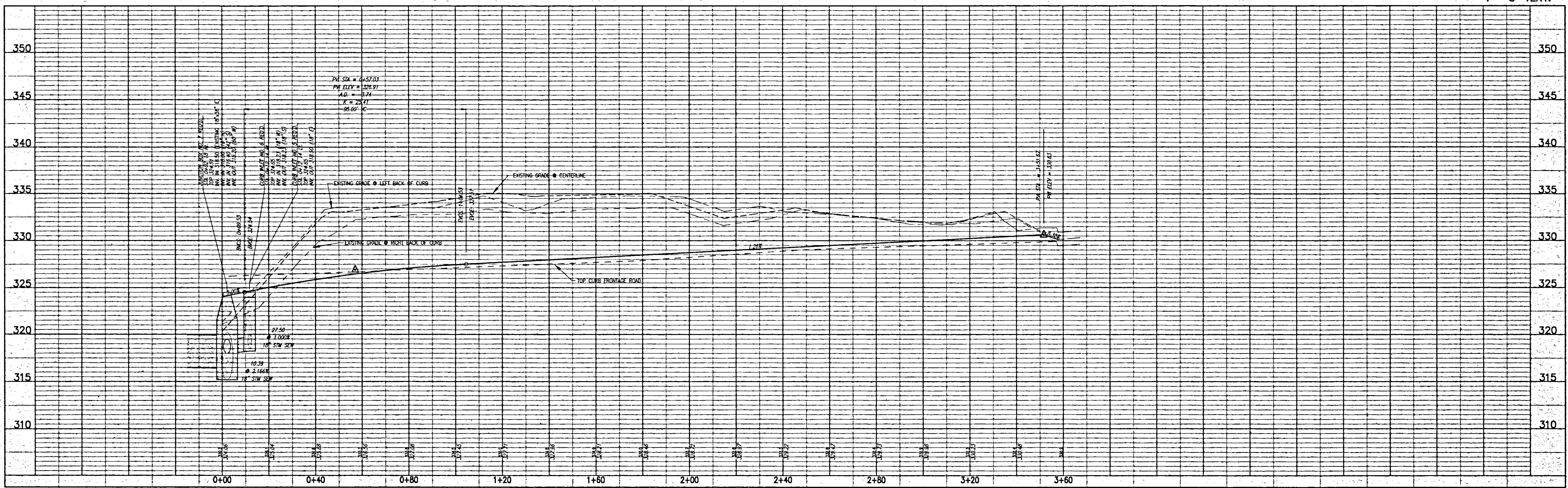

STERLING  
Consultants

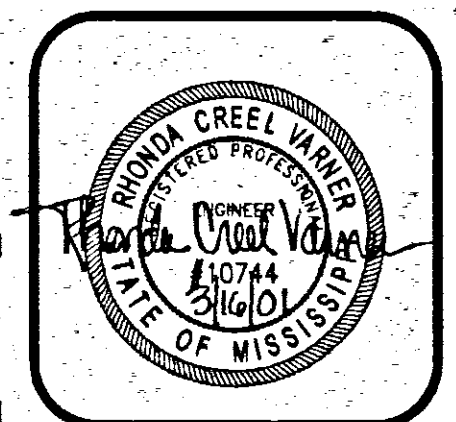

<b>PLAN &amp; PROFILE - ACCESS ROAD</b>	
<b>DRURY INN &amp; SUITES</b> RIDGLAND, MISSISSIPPI	<b>DRUCO, INC.</b> ST. LOUIS, MO.
DWG BY: R.D.B.	REVISIONS:
DATE: 03-16-01	SHEET NO. <b>C-5</b>

C:\Drawings\DRURY\val\site.dwg, P1 Mar 16 11:56:40 2001, R. David Bates - Sterling Consultants, Inc.