

CONSTRUCTION PLANS FOR:
GOT GEAR ADDITION

LOCATION:
 230 US-51
 RIDGELAND, MISSISSIPPI
 JANUARY 2021

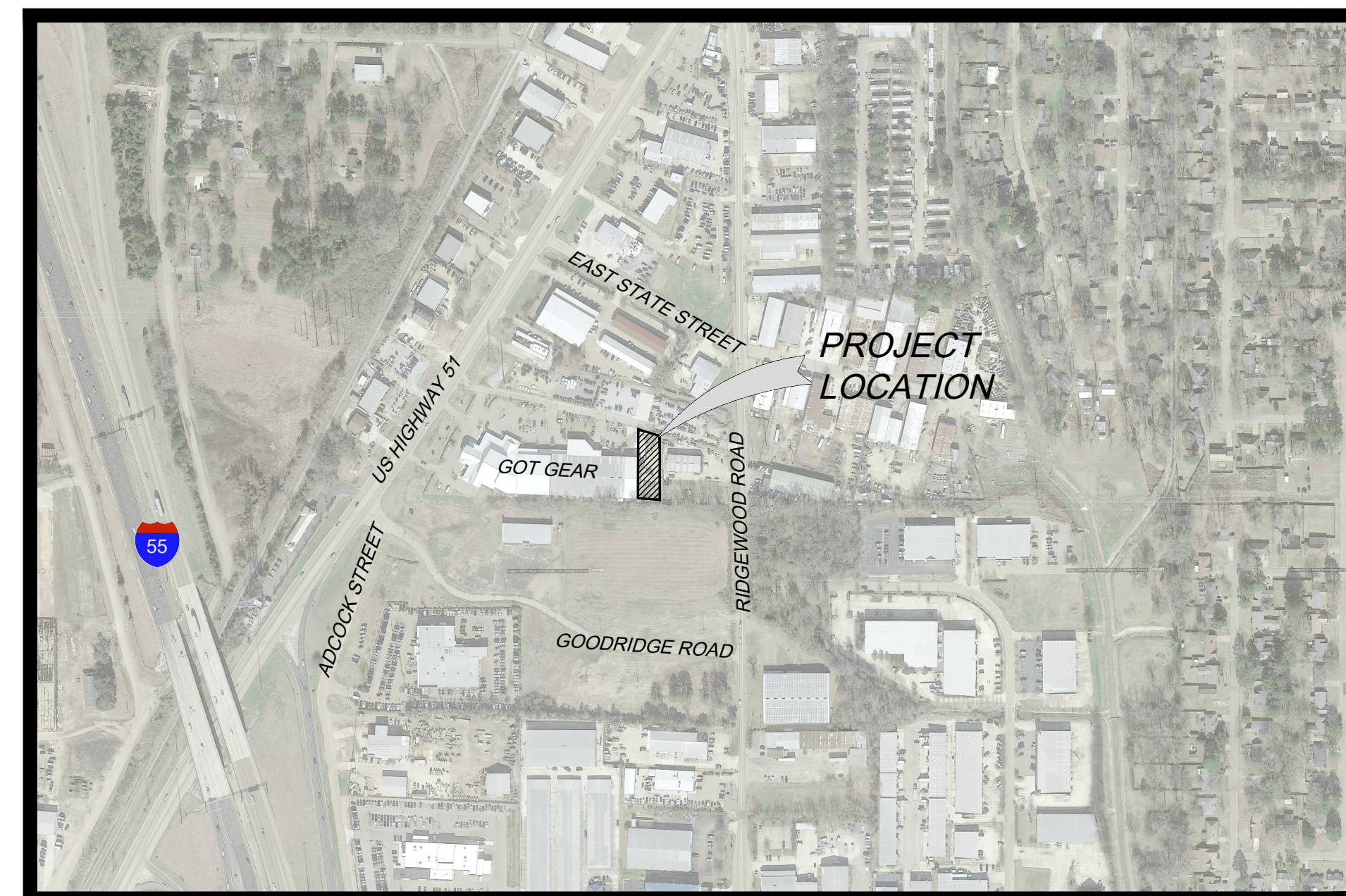
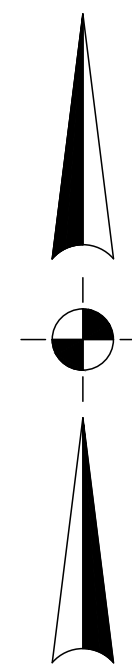

VICINITY MAP

DRAWING INDEX

CONTENTS	SHEET NO.
COVER	1
GENERAL CONSTRUCTION NOTES	2
TYPICAL SECTION & MISCELLANEOUS DETAILS	3
SITE PLAN	4
WATER & SEWER LAYOUT	5
GRADING PLAN	6
EROSION CONTROL LAYOUT	7
WATER & SANITARY SEWER SYSTEM DETAILS	8
EROSION CONTROL DETAILS	9

**FOR REVIEW AND
 APPROVAL**

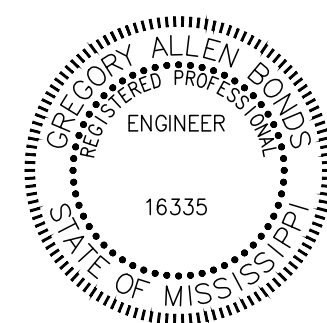

Gregory A. Bonds
 Gregory A. Bonds, P.E.
 Mississippi License No. 16335

1/21/21
 Date

Equipment, materials and construction of all improvements required in these plans shall be in accordance with these construction drawings & project specifications.

The drawings and specifications represented herein are and shall remain the property of Benchmark Engineering & Surveying, LLC and no part thereof shall be copied, disclosed to others or used in connection with any other work or project other than the specific project for which they have been prepared. Visual contact with these drawings or specifications shall constitute evidence of acceptance of these restrictions.

OWNER:
 GOT GEAR
 230 US-51
 RIDGELAND, MS 39157

BENCHMARK
ENGINEERING & SURVEYING, LLC

101 Highpointe Court, Suite B
 Brandon, Mississippi 39042
 601-591-1077

660 Katherine Drive, Suite 302
 Flowood, Mississippi 39232
 601-627-7780

www.benchmarkms.net

SHEET NUMBER	1 of 9
PROJECT NUMBER	B-8262

GENERAL CONSTRUCTION NOTES:

- IT IS NOT THE INTENT OF THESE CONSTRUCTION DRAWINGS, NOTES OR DETAILS TO COVER ALL OF THE REQUIREMENTS OF THE PROJECT SPECIFICATIONS.
- ALL ELEMENTS AND ITEMS NEEDED FOR THE COMPLETE INSTALLATION OF THE IMPROVEMENTS SHOWN IN THESE PLANS THAT ARE NOT SHOWN AS A SEPARATE PAY ITEM SHALL BE CONSIDERED AN ABSORBED COST.
- THE CONTRACTOR SHALL PROVIDE REASONABLE ACCESS TO ALL PROPERTIES IN THE PROJECT AREA THROUGHOUT CONSTRUCTION.
- THE CONTRACTOR SHALL BE RESPONSIBLE FOR FURNISHING ALL LABOR, MATERIALS, EQUIPMENT AND INCIDENTAL ITEMS NEEDED TO PROVIDE ADEQUATE CONSTRUCTION SIGNING, BARRICADES, TRAFFIC CONTROL DEVICES AND OTHER RELATED ITEMS FOR THE PROJECT AREA, DURING THE CONSTRUCTION PERIOD. MAINTENANCE AND PROTECTION OF TRAFFIC MUST COMPLY WITH THE MANUAL OF UNIFORM TRAFFIC CONTROL DEVICES. THIS WORK IS TO BE CONSIDERED AN INCIDENTAL ITEM AND THE COST OF THIS ITEM IS TO BE INCLUDED IN OTHER PAY ITEMS.
- THE CONTRACTOR SHALL FURNISH ALL EFFORT, LABOR, EQUIPMENT AND MATERIALS AS REQUIRED TO PROPERLY, SAFELY AND ACCEPTABLY COMPLETE THE WORK IN A TIMELY MANNER. ALL WORK AND CONSTRUCTION PROCEDURES ARE SUBJECT TO THE APPROVAL OF THE ENGINEER/CITY OF RIDGELAND/OWNER. THE CONTRACTOR WILL BE EXPECTED TO PROGRESS DILIGENTLY AND CONSISTENTLY ITS ACTIVITIES AND OPERATION ON ALL WORKING DAYS WHEN WEATHER AND SOIL CONDITIONS ARE SUITABLE THEREFOR. THE CONTRACTOR SHALL WARRANT HIS WORKMANSHIP AND MATERIALS APPLIED AND INSTALLED FROM THE DATE OF SUCH APPLICATION AND INSTALLATION UNTIL ONE YEAR AFTER ACCEPTANCE OF THE WORK BY THE OWNER.
- ALL EXISTING UTILITY LOCATIONS SHOWN ARE APPROXIMATE AND ARE BASED ON INFORMATION PROVIDED BY OTHERS. THE CONTRACTOR IS RESPONSIBLE FOR CONTACTING THE UTILITY OWNER(S) TO VERIFY THE LOCATION AND ELEVATION OF ALL EXISTING UTILITIES (POWER, TELEPHONE, GAS, WATER, SEWER, ETC.) LOCATED IN THE PROJECT AREA PRIOR TO CONSTRUCTION AND COMPARE HIS FINDINGS AGAINST THE PROPOSED IMPROVEMENTS REQUIRED IN THESE PLANS. SHOULD ANY DISCREPANCIES BE FOUND BETWEEN THE EXISTING CONDITIONS AND PROPOSED IMPROVEMENTS THE CONTRACTOR SHALL NOTIFY THE ENGINEER IMMEDIATELY IN WRITING AND AWAIT FURTHER INSTRUCTION.
- THE CONTRACTOR SHALL BEAR FULL RESPONSIBILITY FOR THE PROTECTION OF ALL PRIVATE AND PUBLIC UTILITIES EVEN THOUGH THEY MAY NOT BE SHOWN ON THE PLANS. ANY UTILITY THAT IS DAMAGED DURING CONSTRUCTION SHALL BE REPAIRED OR REPLACED TO THE SATISFACTION OF THE UTILITY OWNER BY THE CONTRACTOR. THIS INCLUDES ALL SERVICE LATERALS OF ANY KIND.
- THE CONTRACTOR SHALL BE RESPONSIBLE FOR PROTECTING THE INTEGRITY AND OPERATIONS OF ALL ABOVE AND BELOW GROUND UTILITY FACILITIES AT ALL TIMES. THE CONTRACTOR SHALL CONDUCT ITS ACTIVITIES AND OPERATIONS TO INSURE THE FUNCTIONAL INTEGRITY OF EACH UTILITY FACILITY LOCATED WITHIN THE WORK SITE. THE CONTRACTOR ASSUMES FULL RESPONSIBILITY FOR DAMAGE TO ANY UTILITIES ENCOUNTERED WITHIN THE CONSTRUCTION LIMITS WHETHER SHOWN ON THE PLANS OR NOT AND SHALL COORDINATE REPAIR, REPLACEMENT OR RELOCATION WITH THE APPROPRIATE UTILITY COMPANY AT NO COST TO THE OWNER.
- THE CONTRACTOR IS REQUIRED BY LAW TO NOTIFY MISSISSIPPI ONE CALL @ 811 AT LEAST 48 HOURS PRIOR TO CONSTRUCTION TO LOCATE ALL EXISTING UTILITIES ON SITE.
- THE CONTRACTOR WILL NOT BE RESPONSIBLE FOR DEMOLISHING OR REMOVING ANY EXISTING ABOVE OR BELOW GROUND TELEPHONE, CABLE, POWER, OR GAS LINES BUT SHALL BE RESPONSIBLE FOR COORDINATING HIS WORK WITH ALL LOCAL UTILITY COMPANIES.
- THE CONTRACTOR SHALL VERIFY ALL SHOWN DIMENSIONS AND ELEVATIONS (EXISTING AND PROPOSED) IN THE FIELD AND SHALL SATISFY HIMSELF AS TO THE ACCURACY BETWEEN WORK SET FORTH ON THESE PLANS AND THE WORK REQUIRED IN THE FIELD. ANY DISCREPANCIES SHALL BE BROUGHT TO THE ATTENTION OF THE ENGINEER PRIOR TO CONSTRUCTION.
- THE CONTRACTOR SHALL MARK THE CONSTRUCTION LIMITS AND REVIEW WITH THE ENGINEER/OWNER PRIOR TO PERFORMING ANY CLEARING OPERATIONS.
- THE CONTRACTOR SHALL CAREFULLY PROTECT AND PRESERVE ALL SURVEY MARKERS OR MONUMENTS ENCOUNTERED DURING CONSTRUCTION.
- THE CONTRACTOR SHALL UTILIZE TEMPORARY FENCING AS REQUIRED BY LOCAL, STATE AND FEDERAL CODES TO PROTECT AND INSURE A SAFE WORK AREA.
- ALL MATERIAL THAT IS CONSIDERED UNSUITABLE FOR FILL MATERIAL SHALL BE REMOVED FROM THE SITE AND LEGALLY DISPOSED OF BY THE CONTRACTOR.
- THE CONTRACTOR SHALL ESTABLISH A VEGETATIVE COVER (TEMPORARY AND/OR PERMANENT) IN ACCORDANCE WITH THE PROJECT SPECIFICATIONS ON ALL AREAS WHERE THE EXISTING VEGETATION WAS REMOVED OR DISTURBED DURING CONSTRUCTION.
- ALL TESTING SHALL BE DONE BY AN APPROVED TESTING LABORATORY AT THE EXPENSE OF THE CONTRACTOR. THE CONTRACTOR SHALL BE RESPONSIBLE FOR PROVIDING COPIES OF ALL TEST RESULTS TO THE ENGINEER. IF TESTING IS NOT A PAY ITEM IT SHALL BE ABSORBED.
- THE CONTRACTOR SHALL RESTORE ALL DISTURBED AREAS TO MATCH PRE-CONSTRUCTION CONDITION OR BETTER PRIOR TO COMPLETION OF THE PROJECT.
- THE CONTRACTOR SHALL PLACE ALL EXCAVATED MATERIAL IN LOCATIONS TO PREVENT EROSION INTO DRAINAGEWAYS. ALL AREAS DISTURBED BY EXCAVATED MATERIAL PLACEMENT TO BE RESTORED TO ITS ORIGINAL CONDITION.
- ALL EXCAVATIONS ARE TO BE BACKFILLED AT THE END OF EACH WORK DAY.
- ALL FENCING, SIDEWALKS, CURBS, FLOWER BEDS, PLANTERS, ETC. THAT IS DAMAGED DURING CONSTRUCTION WILL BE REPLACED AND RESTORED TO ORIGINAL CONDITION AT NO COST TO THE OWNER.
- THE CONTRACTOR SHALL KEEP ALL ROADS CLEAN OF MUD AND DEBRIS AT ALL TIMES. CONTRACTOR MUST ENSURE THAT ROADS ARE CLEAN PRIOR TO LEAVING THE SITE FOR THE DAY. ALL CLEANING AND MAINTENANCE SHALL BE ABSORBED.
- THE CONTRACTOR SHALL CAREFULLY REMOVE, STORE AND REINSTALL ALL CITY/COUNTY/STATE OWNED SIGNS WHOSE REMOVAL IS REQUIRED BY HIS CONSTRUCTION WORK IN THE PROJECT AREA. IT SHALL BE THE CONTRACTOR'S RESPONSIBILITY TO ARRANGE FOR THE APPROPRIATE AGENCY TO INSPECT ALL SIGNS SCHEDULED TO BE REMOVED PRIOR TO THEIR REMOVAL. ONCE SAID SIGNS HAVE BEEN REMOVED, IT WILL BE ASSUMED THAT THEY WERE IN GOOD CONDITION AT THE TIME OF REMOVAL. ANY SIGNS DAMAGED OR LOST BY THE CONTRACTOR SHALL BE REPLACED AT NO COST TO THE APPROPRIATE AGENCY.
- CONTRACTOR SHALL BE RESPONSIBLE FOR REMOVING ANY AND ALL EXISTING STRUCTURES NECESSARY FOR COMPLETION OF WORK DESCRIBED IN THESE PLANS UNLESS OTHERWISE NOTED.
- ALL GRADING WORK SHALL BE PERFORMED IN A MANNER TO PROMOTE POSITIVE DRAINAGE AND KEEP THE EXISTING DRAINAGE PATTERNS. NO GRADING WORK SHALL ADVERSELY AFFECT ADJACENT PROPERTY OWNERS.
- PRIOR TO SUBMISSION OF ITS BID THE CONTRACTOR SHALL REVIEW THESE PLANS, THE ESTIMATED QUANTITIES FOR THE PRINCIPAL ITEMS OF WORK ON WHICH PAYMENT IS TO BE BASED, AND THE DOCUMENTS REFERENCED HEREIN. SUBMISSION OF ITS BID SHALL BE DEEMED A POSITIVE INDICATION THAT THE CONTRACTOR FOUND ALL OF SAME ADEQUATE FOR SUBMISSION OF A UNIT PRICE BID AND FOR INSTALLATION AND/OR CONSTRUCTION OF THE WORK.
- STATIONING AND LENGTHS (STREET AND UTILITY) IS HORIZONTAL STATIONING MEASURED ON A LEVEL PLANE. ACTUAL LENGTH SHALL BE DETERMINED BY MEASUREMENT ALONG THE SLOPE OR CURVE.
- THE CONTRACTOR SHALL OBTAIN ALL REQUIRED PERMITS AND LICENSES; PAY ALL FEES, CHARGES AND TAXES (INCLUDING SALES AND USE TAXES); GIVE ALL REQUIRED NOTICES; MAINTAIN AN ORDERLY AND SAFE FLOW OF TRAFFIC; MAINTAIN PROPER STORMWATER DRAINAGE; LOCATE AND AVOID DISRUPTING ALL EXISTING UTILITIES; TRANSPORT ALL EQUIPMENT AND MATERIALS AS REQUIRED BY ANY AGENCY HAVING JURISDICTION OVER ANY ROAD USE THEREOF; TRANSPORT, HANDLE AND INSTALL ALL MATERIALS IN ACCORDANCE WITH THEIR RESPECTIVE MANUFACTURER'S RECOMMENDATIONS AND PROJECT SPECIFICATIONS; PROPERLY BACKFILL ALL TRENCHES AND EXCAVATIONS; MAINTAIN A CLEAN AND ORDERLY WORK SITE; PROMPTLY REMOVE ALL EQUIPMENT, DEBRIS AND EXCESS MATERIALS ON COMPLETION OF THE WORK; AND RESTORE TO SUBSTANTIALLY THE SAME OR BETTER CONDITIONS ALL DISTURBED PAVEMENTS AND GROUND SURFACES.
- NO ACTIVITY REQUIRED FOR THE ACCOMPLISHMENT OF THE WORK IS TO BE PERFORMED WHEN SOIL CONDITIONS ARE NOT CONDUCIVE THEREFOR. DRAINAGE SHALL BE MAINTAINED AT ALL TIMES. CONTRACTOR SHALL CONDUCT ITS OPERATIONS AND ACTIVITIES IN SUCH A MANNER AS TO MINIMIZE THE EROSION OF SOILS AND THE DEPOSITION OF SEDIMENTS INTO EXISTING DRAINAGE COURSES DOWNSTREAM OF PROJECT WORK SITE OR ONTO ADJACENT PROPERTIES.
- ELEVATIONS ARE BASED ON M.S.L. DATUM (NAVD 88).

SITE GRADING AND PAVING NOTES:

- TECHNICAL SPECIFICATION FOR MATERIALS AND CONSTRUCTION METHODS FOR PAVING AND EARTHWORK FOR THIS PROJECT SHALL CONFORM TO THE LATEST EDITION OF MISSISSIPPI STANDARD SPECIFICATIONS FOR ROAD AND BRIDGE CONSTRUCTION, AND THESE PLANS AND SPECIFICATIONS. SHOULD THERE BE ANY CONFLICTS BETWEEN THE NOTES STATED HEREIN, THE PROJECT SPECIFICATIONS, AND THE REFERENCED MDOT STANDARDS, MDOT STANDARDS SHALL GOVERN. ANY CONFLICTS NOT RESOLVED BY EITHER OF THESE DOCUMENTS SHALL BE DECIDED BY ARCHITECT/ENGINEER TO REFLECT HIS INTENTION.
- EARTH EXCAVATION SHALL INCLUDE CLEARING, STRIPPING, AND THE STOCKPILING OF TOPSOIL, REMOVING UNSUITABLE MATERIALS, THE CONSTRUCTION OF EMBANKMENTS, NON-STRUCTURAL FILLS, FINAL SHAPING AND TRIMMING TO THE LINES, GRADES AND CROSS SECTIONS SHOWN ON THE PLANS. ALL UNSUITABLE OR EXCESS MATERIAL SHALL BE DISPOSED OF AS DIRECTED BY THE ENGINEER.
- AS AN INITIAL STEP OF SITE PREPARATION, TREES AND VEGETATION WITHIN THE CONSTRUCTION LIMITS SHOULD BE REMOVED. TREE AND VEGETATION REMOVAL (CLEARING AND GRUBBING) WILL INCLUDE STUMPS AND ROOT SYSTEMS. HOLES CREATED BY TREE AND STUMP REMOVAL SHALL BE BACKFILLED WITH SELECT FILL SOILS AND COMPACTED PER SPECIFICATIONS AS DIRECTED BY ENGINEER.
- AFTER CLEARING AND GRUBBING, STRIPPING (12" MINIMUM DEPTH) SHOULD BE PERFORMED TO A SUFFICIENT DEPTH WITHIN CONSTRUCTION AREAS TO REMOVE ORGANIC-LADEN SURFICIAL SOILS, VEGETATION, DEBRIS, BRUSH AND ROOTS (TOPSOIL). TOPSOIL EXCAVATED SHALL BE STOCKPILED ON THE SITE IN AREAS DESIGNATED BY THE ENGINEER UNTIL SUCH TIME THAT THIS TOPSOIL CAN BE USED FOR FINAL GRADING. THIS IS NOT A PAY ITEM, BUT SHALL BE AN ABSORBED COST.
- ONCE CLEARING, GRUBBING, AND STRIPPING HAS BEEN COMPLETED THE CONTRACTOR SHALL EXCAVATE AREAS THAT ARE TO BE CUT TO REACH PLAN GRADE. CONTRACTOR SHALL THEN NOTIFY THE ENGINEER FOR A FIELD INSPECTION OF THE SUBGRADE PRIOR TO PLACEMENT OF ANY SELECT FILL. CONTRACTOR SHALL HAVE EQUIPMENT AVAILABLE TO PERFORM A PROOF ROLL OR FOR FURTHER EXCAVATION SHOULD THE ENGINEER DEEM NECESSARY. FINE-GRAINED SOILS EXPOSED AFTER STRIPPING, EXCAVATION AND UNDERCUTTING ARE SUSCEPTIBLE TO PUMPING AND/OR BECOMING UNSTABLE UNDER WET CONDITIONS. THE CONSTRUCTION TECHNIQUES, TYPES OF EQUIPMENT UTILIZED AND SITE DRAINAGE PROVIDED DURING CONSTRUCTION WILL HAVE A GREAT EFFECT ON THE PERFORMANCE OF THE FINE-GRAINED SOILS THROUGHOUT THE PROJECT. THE ROUTING OF RUBBER-TIRED EQUIPMENT SHOULD BE CONTROLLED TO MINIMIZE TRAFFIC OVER THE SITE. ALL TRAFFIC SHOULD BE DISCOURAGED DURING PERIODS OF INCLEMENT WEATHER.
- UNDERCUTTING AND BACKFILLING WILL BE REQUIRED TO REMOVE EXPANSIVE CLAYS (CH) IF PRESENT AND CREATE THE RECOMMENDED SOIL BUFFER DESCRIBED BELOW AT BUILDING STRUCTURE LOCATIONS AS DIRECTED BY THE OWNER AND AT ALL PAVEMENT AND SIDEWALK LOCATIONS.
- IMPORT SELECT FILL MATERIAL SHALL CONSIST OF SELECT, NON-ORGANIC AND DEBRIS-FREE SILTY CLAYS (CL) HAVING A PLASTICITY INDEX (PI) WITHIN THE RANGE OF 8 TO 22 AND A LIQUID LIMIT LESS THAN 40. TO BE CLASSIFIED AS SILTY CLAYS (CL) THE FILL MATERIALS MUST HAVE MORE THAN 70% FINES PASSING THE NUMBER 200 SIEVE.
- IMPORT SELECT, STRUCTURAL FILL MATERIAL SHALL CONSIST OF SELECT, NON-ORGANIC AND DEBRIS-FREE SILTY CLAYS (CL) HAVING A PLASTICITY INDEX (PI) WITHIN THE RANGE OF 8 TO 20 AND A LIQUID LIMIT LESS THAN 40. TO BE CLASSIFIED AS SILTY CLAYS (CL) THE FILL MATERIALS MUST HAVE MORE THAN 70% FINES PASSING THE NUMBER 200 SIEVE.
- RECOMMENDED SOIL BUFFER FOR THE BUILDINGS TO BE 7" THICK AND EXTEND Laterally NOT LESS THAN 3' BEYOND THE STRUCTURE LIMITS.
- RECOMMENDED SOIL BUFFER FOR PAVEMENT AND SIDEWALK IS TO BE 3" THICK AND EXTEND Laterally NOT LESS THAN 3' BEYOND PAVEMENT, SIDEWALK EDGES.
- FILL SOILS SHOULD BE COMPACTED IN LIFTS NOT EXCEEDING 6" IN LOOSE THICKNESS TO NOT LESS THAN 98% OF THE STANDARD PROCTOR DENSITY (ASTM D-698-91) AT MOISTURE CONTENTS WITHIN 2 PERCENTAGE POINTS OF THE OPTIMUM WATER CONTENT. STABILITY MUST BE EVIDENT DURING COMPACTION OF EACH LIFT BEFORE ANY SUBSEQUENT LIFTS OF FILL MATERIAL ARE ADDED.
- FIELD MOISTURE/DENSITY TESTS SHALL BE PERFORMED FREQUENTLY IN THE SCARIFIED AND COMPACTED ON-SITE SOILS AND IN EACH COMPACTED LIFT OF FILL MATERIAL. TESTS TO BE PERFORMED A MINIMUM OF ONE TEST PER LIFT FOR EACH 2,000 S.F. OF SURFACE AREA FOR THE BUILDING PAD CONSTRUCTION AND ONE TEST PER LIFT FOR EACH 5,000 S.F. OF SURFACE AREA FOR THE PARKING LOT AND DRIVEWAYS. TEST RESULTS TO BE FAXED TO BENCHMARK ENGINEERING & SURVEYING, LLC AT 601-591-0711. A PROOF ROLL OF THE SUB-GRADE FOR THE CURB AND PARKING LOT IS ALSO REQUIRED PRIOR TO PLACEMENT OF CURB & GUTTER AND ASPHALT BASE. CONTRACTOR SHALL NOTIFY ENGINEER AT A MINIMUM OF 48 HOURS PRIOR.
- THE GRADING AND CONSTRUCTION OF THE SITE IMPROVEMENTS SHALL NOT CAUSE THE PONDING OF STORM WATER. ALL AREAS ADJACENT TO THESE IMPROVEMENTS SHALL BE GRADED TO ALLOW POSITIVE DRAINAGE. POSITIVE DRAINAGE SHALL BE MAINTAINED AT ALL TIMES.
- THE CONTRACTOR SHALL TAKE SPECIAL CARE IN GRADING NEAR TREES, BUSHES AND SHRUBS WHICH ARE NOT TO BE REMOVED SO AS NOT TO CAUSE INJURY TO ROOTS OR TRUNKS.
- THE CONTRACTOR SHALL USE CARE IN GRADING OR EXCAVATION NEAR ANY AND ALL EXISTING ITEMS WHICH ARE NOT INDICATED TO BE REMOVED. ANY DAMAGE DONE TO THESE EXISTING ITEMS BY THE CONTRACTOR'S OPERATIONS SHALL BE REPAIRED AT THE CONTRACTOR'S EXPENSE.
- PROPOSED ELEVATIONS INDICATE FINISHED CONDITIONS. FOR ROUGH GRADING ELEVATIONS ALLOW FOR THICKNESS OF PROPOSED ITEMS (ROADS, WALKS, DRIVES, ETC.) OR TOPSOIL AS SHOWN.
- STREET PAVING AND CURBS TO REMAIN SHALL BE PROTECTED FROM DAMAGE, AND IF DAMAGED, SHALL BE REPLACED PROMPTLY.

WATER & SEWER NOTES:

- ALL MATERIALS AND CONSTRUCTION SHALL BE IN ACCORDANCE WITH THESE PLANS AND PROJECT SPECIFICATIONS.
- THE CONTRACTOR SHALL PROVIDE ALL THE MATERIALS AND APPURTENANCES NECESSARY FOR THE COMPLETE INSTALLATION OF THE WATER AND SEWER UTILITIES.
- THE CONTRACTOR SHALL MAKE ALL TIES TO EXISTING UTILITIES AND COORDINATE WITH THE CITY OF RIDGELAND.
- ALL MANHOLES, FIRE HYDRANTS, VALVE BOXES, ETC. LOCATED IN PROJECT AREA SHALL BE ADJUSTED TO PROPER LINE AND FINISHED GRADE BY THE CONTRACTOR AFTER PLACING OF PAVEMENT AND BEFORE FINAL ACCEPTANCE.
- TRENCHING AND EMBEDMENT WORK SHALL CONFORM TO THE PROJECT SPECIFICATIONS AND SHALL FOLLOW THE TYPICAL CROSS-SECTION DETAIL FOR TRENCHING. UNLESS SPECIFIED OTHERWISE, BACKFILL MATERIAL SHALL BE COMPACTED TO 98% DENSITY OF STANDARD PROCTOR IN ACCORDANCE WITH ASTM D-698. ALL BACKFILL MATERIAL SHALL BE COMPACTED IN 6" LAYERS.
- THE END OF WATER AND SEWER SERVICE LINES SHALL BE TIGHTLY CAPPED OR PLUGGED AND MARKED.
- ALL WATER AND SANITARY SEWER LINES SHALL BE INSTALLED WITH A MINIMUM OF THREE FEET (3') OF COVER OVER THE TOP OF THE PIPE AT FINISHED GRADE OR AS SHOWN OR NOTED OTHERWISE. WHERE INSTALLED IN A ROADWAY SECTION THE MINIMUM COVER OVER THE TOP OF THE PIPE SHALL BE FOUR FEET (4'). BACKFILL SHALL BE PLACED IN 6" LIFTS AND COMPACTED TO 98% STANDARD PROCTOR DENSITY.
- WATER LINE SHALL BE INSTALLED TO MAINTAIN A MINIMUM CLEARANCE OF 12" BELOW OR ABOVE EXISTING OR PROPOSED STORM DRAIN PIPING AND STRUCTURES THAT ARE PARALLEL TO OR INTERSECT THE WATER MAIN WHILE MAINTAINING THE MINIMUM COVER REQUIREMENTS.
- TEN FEET (10') OF HORIZONTAL CLEARANCE IS REQUIRED BETWEEN ALL WATER AND SEWER LINES. AT LOCATIONS WHERE THE WATER AND SEWER LINES MUST CROSS EACH OTHER THERE SHALL BE A MINIMUM CLEARANCE OF 18" WITH THE WATER PASSING OVER THE SEWER. IF THESE SEPARATIONS CANNOT BE MET, THE SEWER LINE SHALL BE CONSTRUCTED TO THE SAME SPECIFICATIONS AS THE WATER LINE AND BE WATER TIGHT UNTIL SUCH A POINT WHERE MINIMUM SEPARATION CAN BE MET. WHERE GRAVITY FLOW SEWERS CROSS ABOVE WATER LINES, THE SEWER PIPE FOR A DISTANCE OF TEN (10') FEET, EACH SIDE OF THE CROSSING, EITHER SHALL BE DUCTILE IRON PRESSURE PIPE WITHOUT ANY JOINT CLOSER THAN THREE (3') FEET TO THE CROSSING, OR SHALL BE FULLY ENCASED IN CONCRETE.
- THE UTILITY CONTRACTOR SHALL BE RESPONSIBLE FOR TESTING THE WATER AND SEWER SYSTEM IN ACCORDANCE WITH THE SPECIFICATIONS AND SHALL NOTIFY THE ENGINEER AND THE CITY OF RIDGELAND AT LEAST 48 HOURS IN ADVANCE OF PERFORMING ANY TESTS. A COPY OF ALL TEST RESULTS SHALL BE FAXED TO BENCHMARK ENGINEERING & SURVEYING, LLC @ 601-591-0711.
- ALL DISCONNECTIONS OR CONNECTIONS TO EXISTING WATER AND SEWER SYSTEM SHALL BE MADE DURING OFF-PEAK PERIODS AND COORDINATED WITH THE CITY OF RIDGELAND.

EROSION CONTROL NOTES:

- ALL ITEMS SHOWN ON THE CONTRACT DRAWINGS AND ALL ITEMS REQUIRED TO STAY IN COMPLIANCE WITH THE REQUIREMENTS OF THE CITY OF RIDGELAND AND THE MISSISSIPPI DEPARTMENT OF ENVIRONMENTAL QUALITY (MDEQ), SHALL BE INCLUDED IN THE CONTRACTOR'S SCOPE AND PRICE.
- EROSION CONTROL ITEMS DEPICTED ON THE CONTRACT DRAWINGS ARE THE MINIMUM REQUIREMENTS. CONTRACTOR IS RESPONSIBLE TO INSTALL ADDITIONAL ITEMS AS NEEDED TO MEET ABOVE MENTIONED REQUIREMENTS.
- THE CONTRACTOR SHALL TAKE ALL NECESSARY MEASURES TO CONTROL EROSION AND STORM WATER POLLUTION THROUGHOUT THE CONSTRUCTION PERIOD IN ACCORDANCE WITH THE REQUIREMENTS OF THE MDEQ. THIS INCLUDES BUT IS NOT LIMITED TO PROPER INSTALLATION AND MAINTENANCE OF ALL TEMPORARY AND PERMANENT MEASURES, INSPECTIONS, INSPECTION REPORTS, AND UPDATES TO EROSION CONTROL PLAN SHOWING FAILURES, REPAIRS AND ADDITIONAL MEASURES TAKEN.
- ALL TEMPORARY EROSION CONTROL MEASURES SHALL BE IN PLACE BEFORE ANY CONSTRUCTION ACTIVITIES BEGIN.
- CLEARING AND GRUBBING SHALL BE HELD TO THE MINIMUM WIDTH NECESSARY TO ACCOMMODATE IMPROVEMENTS.
- EMBANKMENTS AND EXCAVATED AREAS SHALL BE PROMPTLY STABILIZED TO MINIMIZE EROSION.
- WATTLE EROSION CHECKS, SILT FENCING OR OTHER APPROVED BMP'S SHALL BE USED ALONG THE TOE OF FILL SLOPES, IN DITCHES, AND IN OTHER AREAS WHERE EROSION IS A PROBLEM AND SILT LADEN RUNOFF MAY ENTER A STREAM, DITCH OR ADJACENT PROPERTY.
- ANY STOCKPILED SOIL OR FILL MATERIAL SHALL BE LOCATED AND TREATED IN A MANNER TO PREVENT SILT FROM ENTERING STREAMS, DITCHES OR ADJACENT PROPERTY. NO EXCAVATED MATERIAL SHALL BE DISCHARGED FROM THE CONSTRUCTION LIMITS. THE CONTRACTOR SHALL DISPOSE OF ALL EXCAVATED MATERIAL IN A LOCATION APPROVED BY THE ENGINEER.
- ALL SOIL EROSION AND SEDIMENT CONTROL MEASURES SHALL BE CONTINUALLY MAINTAINED. THE CONTRACTOR SHALL KEEP ALL AREAS ADJACENT TO THE LIMITS OF CONSTRUCTION FREE OF MUD AND DEBRIS.
- CONTRACTOR SHALL COMPLY WITH THE EROSION CONTROL REQUIREMENTS OF CITY OF RIDGELAND AND THE REQUIREMENTS OF THE MISSISSIPPI DEPARTMENT OF ENVIRONMENTAL QUALITY.
- CONTRACTOR TO UTILIZE APPROVED BEST MANAGEMENT PRACTICES FOR EROSION AND SEDIMENT CONTROL.
- ALL DISTURBED AREAS NOT PAVED SHALL BE SEEDED, MULCHED, FERTILIZED AND WATERED AS REQUIRED TO PREVENT EROSION.
- ALL EROSION CONTROL DEVICES SHALL REMAIN IN PLACE UNTIL THE DISTURBED UPSTREAM AREA HAS BEEN INSPECTED BY THE ENGINEER AND APPROVAL HAS BEEN GIVEN FOR REMOVAL.
- CONTRACTOR WILL PROVIDE A STORAGE AREA FOR ALL POTENTIALLY TOXIC MATERIALS THAT ARE TO BE STORED ON SITE. THE LOCATION OF THIS AREA SHALL BE COORDINATED WITH THE ENGINEER/CITY OF RIDGELAND.
- FUEL AND MATERIAL STORAGE AREAS SHALL BE LOCATED AS FAR AWAY FROM ANY DITCHES OR STREAMS AS POSSIBLE. A 60ML POLYETHYLENE LINER IS REQUIRED UNDER FUEL TANKS.
- CONTRACTOR WILL BE RESPONSIBLE FOR ANY REPAIRS OR REPLACEMENT REQUIRED TO RESTORE AREAS TO THEIR ORIGINAL CONDITION WHERE EROSION CONTROL MEASURES FAILED.

STANDARD ABBREVIATIONS, SYMBOLS & LINETYPES

ABBREVIATIONS

#	POUND
ASBY	ASSEMBLY
AVG	AVERAGE
B.F.E	BASE FLOOD ELEVATION
BLDG	BUILDING
BM	BENCHMARK
C	CHORD LENGTH
CI	CENTERLINE
CI	CURB INLET
CONC	CONCRETE
CONST	CONSTRUCTION
C.M.P.	CORRUGATED METAL PIPE
C.P.P.	CORRUGATED PLASTIC PIPE
C.Y.	CUBIC YARD
DIAM	DIAMETER
D.I.P.	DUCTILE IRON PIPE
DBL	DOUBLE
DWG	DRAWING
EASE	EASEMENT
EA	EACH
EASE	EASEMENT
EP	EDGE OF PAVEMENT
EX	EXISTING
EXIST	EXISTING
EXT	EXTENSION
E.W.	EACH WAY
F.F.E.S.	FLARED END SECTION
F.F.E.	FINISHED FLOOR ELEVATION
E	FLOWLINE (EQUALS INVERT)
FM	SANITARY SEWER FORCE MAIN
GV	GATE VALVE
GI	GRATE INLET
HORIZ	HORIZONTAL
Hwy.	HIGHWAY
HYD	HYDRANT
INV.	INVERT (EQUALS FLOWLINE)
JB	JUNCTION BOX
LB	LOAD
L.F.	LINEAR FEET (HORIZONTAL)
MAX	MAXIMUM
MH	SANITARY SEWER MANHOLE
MIN	MINIMUM
MJ	MECHANICAL JOINT
N.T.S.	NOT TO SCALE
O.C.	ON CENTER
PC	POINT OF CURVATURE
PERM	PERMANENT
PI	POINT OF INTERSECTION
PROP	PROPOSED
PT	POINT OF TANGENCY
R	RADIUS
R.C.P.	REINFORCED CONCRETE PIPE
R.C.A.P.	REINFORCED CONCRETE ARCH PIPE
RD	ROAD
REQ'D	REQUIRED
RET. WALL	RETAINING WALL
R.O.W./ROW	RIGHT OF WAY
RR	RAILROAD
SD	STORM DRAIN
SHLDR	SHOULDER
SS	SANITARY SEWER
STA.	STATION
STD.	STANDARD
S.Y.	SQUARE YARD
T	TANGENT LENGTH
TBC	TOP BACK OF CURB
TBM	TEMPORARY BENCHMARK
TEMP.	TEMPORARY
TOE	TOE OF SLOPE
TP	TOP OF BANK
TP	TOP OF PAVEMENT (ALL TYPES)
TRP	TRIPLE
TS	TOP OF SIDEWALK
TYP.	TYPICAL
VERT.	VERTICAL

SYMBOLS

●	PROP. SS MH
○	PROP. SS CLEANOUT
□	PROP. CI (SINGLE)
□	PROP. CI (SINGLE EXT.)
○	PROP. CI (DBL. EXT.)
○	PROP. GRATE INLET
○	PROP. JB
+	PROP. FIRE HYDRANT ASSY.
+	PROP. GATE VALVE ASSY.
○	PROP. SPOT ELEV. TOP BACK OF CURB
○	PROP. SPOT ELEV. TOP OF SIDEWALK
○	TEMP. BM
○	PROP. WATER METER ASSY.
○	PROP. BACKFLOW ASSY.
○	EX. POWER POLE
○	EX. SS MH
○	EX. SS LIFT STATION
○	EX. GATE VALVE ASSY.
○	EX. WATER METER ASSY.
○	SET IRON PIN
○	FOUND IRON PIN
○	BORE HOLE LOCATION
○	EX. CI
○	EX. CI (SINGLE EXT.)
○	EX. CI (DBL. EXT.)
○	PROP. SS MH LABEL
○	PROP. SD STRUCTURE LABEL
○	EX. FIRE HYDRANT ASSY.
○	PROP. CENTERLINE
○	EX. F.E.S.
○	PROP. WATTLE
○	F.E.S. INLET PROTECTION
○	PROP. CI PROTECTION ON SLOPE
○	PROP. CI PROTECTION IN SAG
○	PROP. GI PROTECTION

LINETYPES

---	EX. ADJACENT PROPERTY LINE
---	EX. AT&T LINE
---	EX. BLDG. LINE
---	EX. G. ROAD
---	EX. COMCAST UNDERGROUND
---	EX. CONC.
---	EX. CULVERT
---	EX. CURB
---	EX. DITCH
---	EX. EASE.
---	EX. EDGE OF BARBED WIRE
---	EX. FENCE CYCLONE
---	EX. FENCE WROUGHT IRON
---	EX. FENCE WOOD
---	EX. FIBER OPTIC
---	EX. GAS LINE
---	EX. GROUND CONTOUR LINE
---	EX. LANDSCAPING
---	EX. POWER (OVERHEAD)
---	EX. POWER (UNDERGROUND)
---	EX. RET. WALL
---	EX. RR TRACKS
---	EX. SIDEWALK
---	EX. SS
---	EX. STRIPING
---	EX. TOE SLOPE
---	EX. TOP BANK
---	EX. TREE LINE
---	EX. WATER'S EDGE
---	EX. WATER LINE
---	BASE FLOOD ELEVATION LINE & ELEV. FLOODWAY LINE
---	FLOOD ZONE LINE
---	PROP. EP
---	PROP. CASING
---	PROP. CENTERLINE
---	PROP. CLEARING LIMITS
---	PROP. CURB
---	PROP. EASE
---	PROP. FENCE BARBED WIRE
---	PROP. FENCE CYCLONE
---	PROP. FENCE WROUGHT IRON
---	PROP. FENCE WOOD
---	PROP. FINISHED GRADE CONTOUR LINE
---	PROP. SHOULDER
---	PROP. GAS LINE
---	PROP. PHASE LINE
---	PROP. PROPERTY
---	PROP. RET. WALL
---	PROP. R.O.W.
---	PROP. SD CULVERT
---	PROP. SETBACKS
---	PROP. SIDEWALK
---	PROP. SILT FENCE
---	PROP. SS FM
---	PROP. SS LINE
---	PROP. SS SERVICE LINE
---	PROP. SWALE/DRAIN PATH
---	PROP. WATER EDGE
---	PROP. WATER LINE
---	PROP. WATER SERVICE LINE

HATCHES

▨	FLOOD ZONE AE
▨	FLOOD ZONE X (SHADED)
▨	HEAVY DUTY ASPHALT
▨	BLDG.
▨	CONC.
▨	RIP-RAP
▨	CONST. ROAD
▨	TOP OF BANK
▨	TOP OF PAVEMENT (ALL TYPES)
▨	TRIPLE
▨	TOP OF SIDEWALK
▨	TYPICAL
▨	VERTICAL

NOT FOR CONSTRUCTION

BENCHMARK ENGINEERING & SURVEYING, LLC
 609 Katherine Drive, Suite 302
 Ridgeland, MS 39157
 Phone: 601-591-1871
 Fax: 601-591-1870
 www.benchmarkms.com

DATE: 07/21/21
 CHECKED: GAB
 REF C/L:
 EC SURFACE:
 FS SURFACE:

PROJECT LOCATION:
 230 US-51
 RIDGELAND, MISSISSIPPI
 CLIENT:
 GOT GEAR
 230 US-51, RIDGELAND, MISSISSIPPI

PROJECT:
 GOT GEAR ADDITION
 SHEET CONTENTS:
 GENERAL NOTES

SHEET NUMBER
 2 of 9
 PROJECT NUMBER
 B-8262

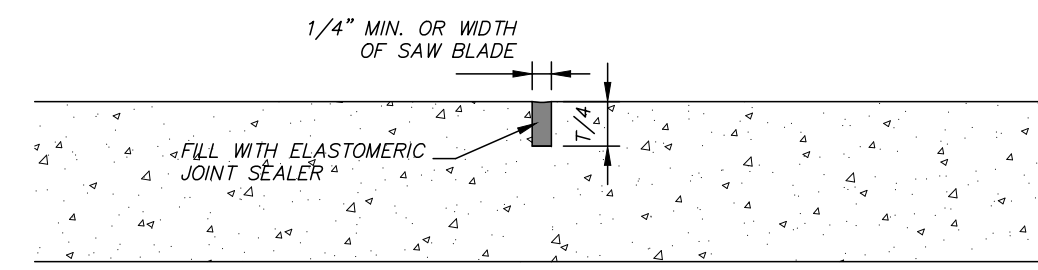

NOTE:

- CONTRACTION JOINTS TO BE SAWS PER ACI STANDARDS TO ALLOW FOR SMOOTH, CLEAN, FINISHED EDGES AND AT INTERVALS ACCORDING TO ACI STANDARDS. PANELS WITH RAVELED EDGES FROM SAW CUTTING WILL BE REJECTED SHALL BE REMOVED & REPLACED BY CONTRACTOR AT NO COST TO THE OWNER.

CONTRACTION JOINT DETAIL

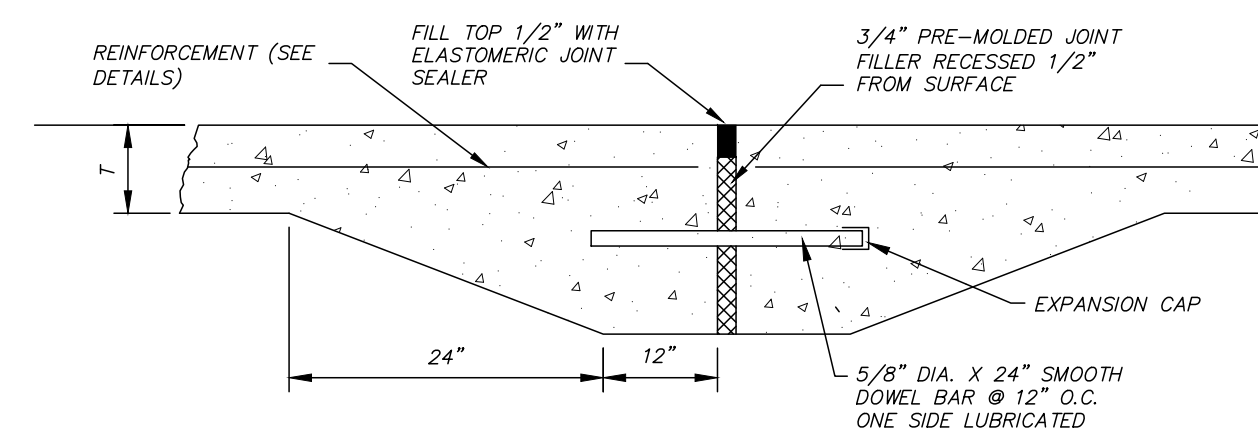

TRANSVERSE EXPANSION JOINT DETAIL

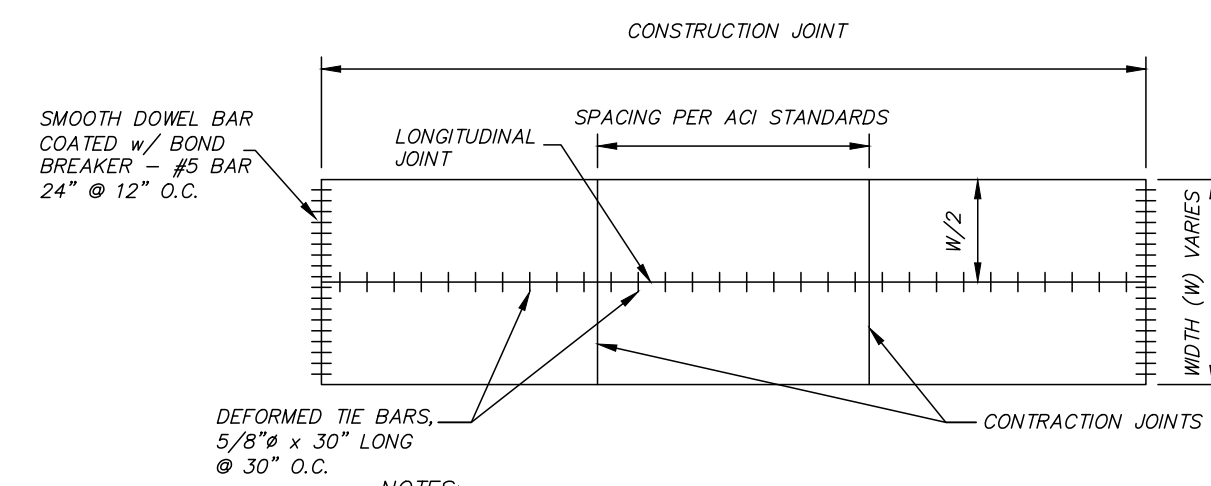

- NOTES:
- LONGITUDINAL JOINTS REQUIRED ON PAVEMENT THAT IS 20' OR WIDER AND IS TO BE CENTERED.
 - SEE DETAILS FOR MORE INFORMATION OF JOINT CONSTRUCTION AND DOWEL BARS.
 - KEY TYPE JOINT SHALL BE USED ON ALL LONGITUDINAL JOINTS WHEN ADJACENT LANE IS NOT POURED AT THE SAME TIME.

TYPICAL JOINT SPACING FOR RIGID PAVEMENT

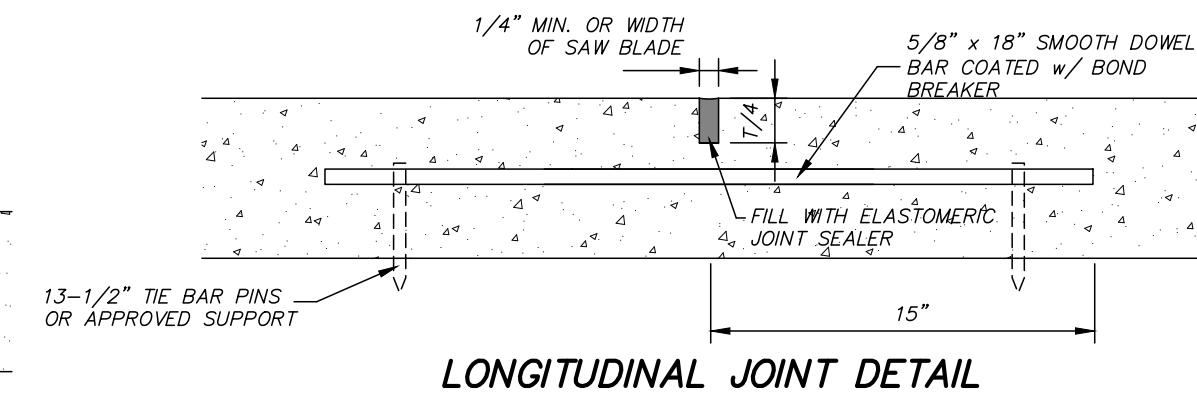

LONGITUDINAL JOINT DETAIL

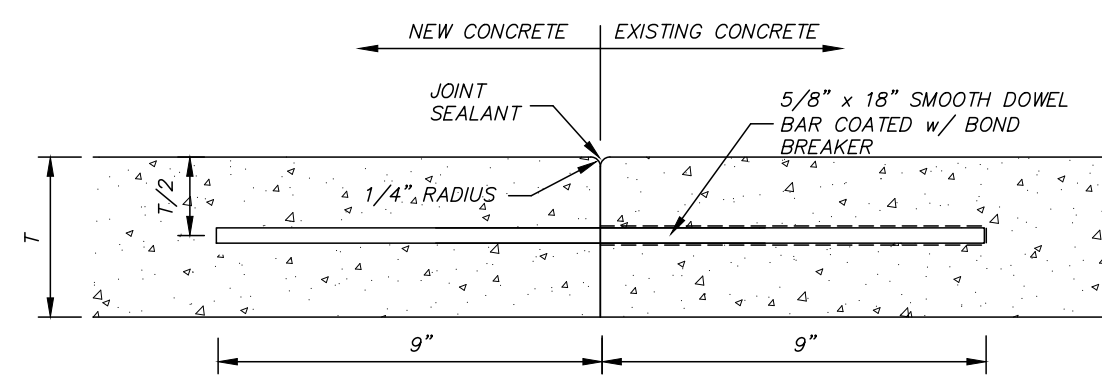

NOTES:

- REQUIRED AT ALL LOCATIONS WHERE PROPOSED PAVEMENT TIES TO EXISTING PAVEMENT UNLESS OTHERWISE NOTED.
- DRILL HOLE INTO EX. CONCRETE PAVEMENT TO LENGTH REQUIRED, USE CHEMICAL ADHESIVE TO BAR TO EXISTING CONCRETE.
- DOWEL BAR LOCATION TO MATCH TIE BAR SPACING WHERE APPLICABLE, MINIMUM SPACING OF 18".
- 1/4" RADIUS NOT REQ'D. ON EXISTING CONCRETE IF NOT ALREADY THERE.
- SEE DETAILS FOR PAVEMENT THICKNESS.

PROPOSED CONCRETE PAVEMENT TO EXISTING CONCRETE PAVEMENT DETAIL

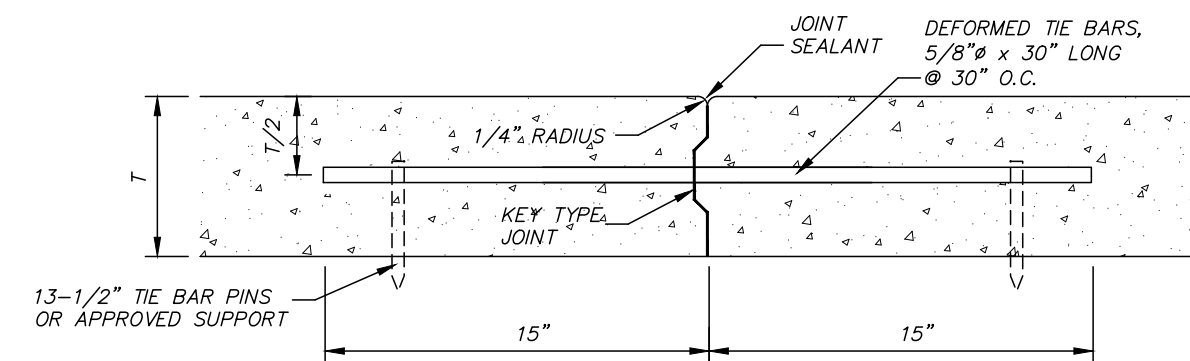

NOTES:

- KEY TYPE JOINT SHALL BE USED ON ALL LONGITUDINAL CONSTRUCTION JOINTS WHEN ADJACENT LANE IS NOT POURED AT THE SAME TIME.
- ALTERNATIVE METHODS FOR KEY TYPE JOINT SHALL BE PRESENTED TO ENGINEER FOR APPROVAL PRIOR TO INSTALLATION.

CONSTRUCTION JOINT DETAIL

CONCRETE ROADWAY DETAILS

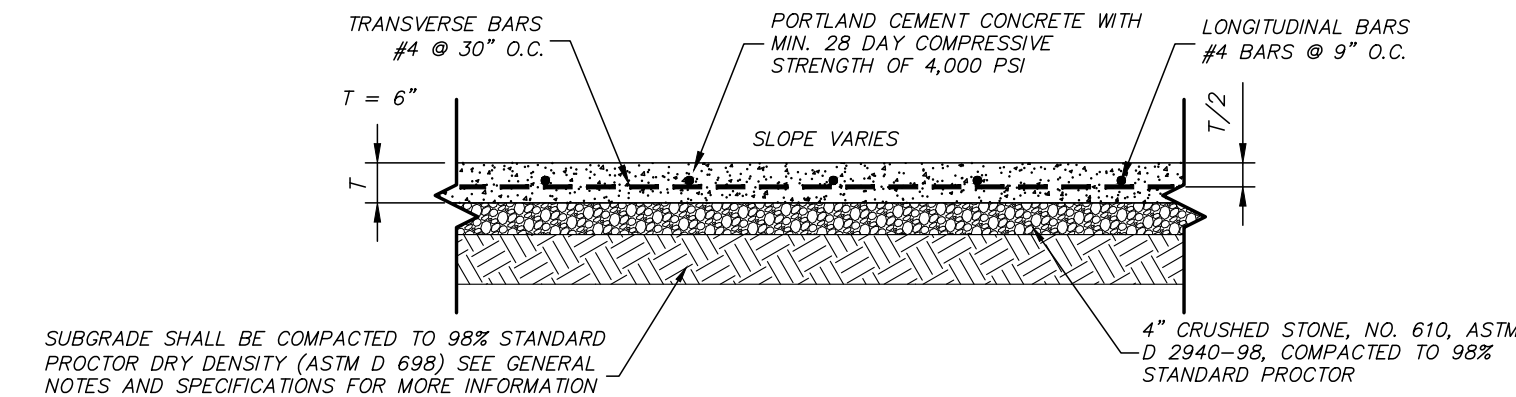

SUBGRADE SHALL BE COMPACTED TO 98% STANDARD PROCTOR DRY DENSITY (ASTM D 698) SEE GENERAL NOTES AND SPECIFICATIONS FOR MORE INFORMATION ON PREPARING SUBGRADE

CONCRETE PAVING STANDARD DUTY

NOTES:

- PORTLAND CEMENT CONCRETE SHALL MEET OR EXCEED 3,500psi AT 28 DAYS.
- REBAR SHALL MEET ASTM A 615, GRADE 60 REQUIREMENTS.
- REBAR SHALL NOT BE PLACED WITHIN 1" FROM EDGE OF PAVEMENT.
- EXPANSION, ISOLATION AND CONTROL JOINTS SHALL BE PLACED AS REQUIRED PER SPECS AND SPACED PER ACI RECOMMENDATIONS FOR CONCRETE THICKNESS.

TYPICAL SECTIONS OF RIGID PAVEMENT STRUCTURES

DATE:	07/21/21	DRAWN:	KDR
CHECKED:	GAB	SCALE:	
REF C/L:		EC SURFACE:	
		FG SURFACE:	

PROJECT LOCATION:	230 US-51 RIDGELAND, MISSISSIPPI
CLIENT:	GOT GEAR 230 US-51, RIDGELAND, MISSISSIPPI

PROJECT:	GOT GEAR ADDITION
SHEET CONTENTS:	TYPICAL SECTION & MISCELLANEOUS DETAILS

SHEET NUMBER	3 of 9
PROJECT NUMBER	B-8262

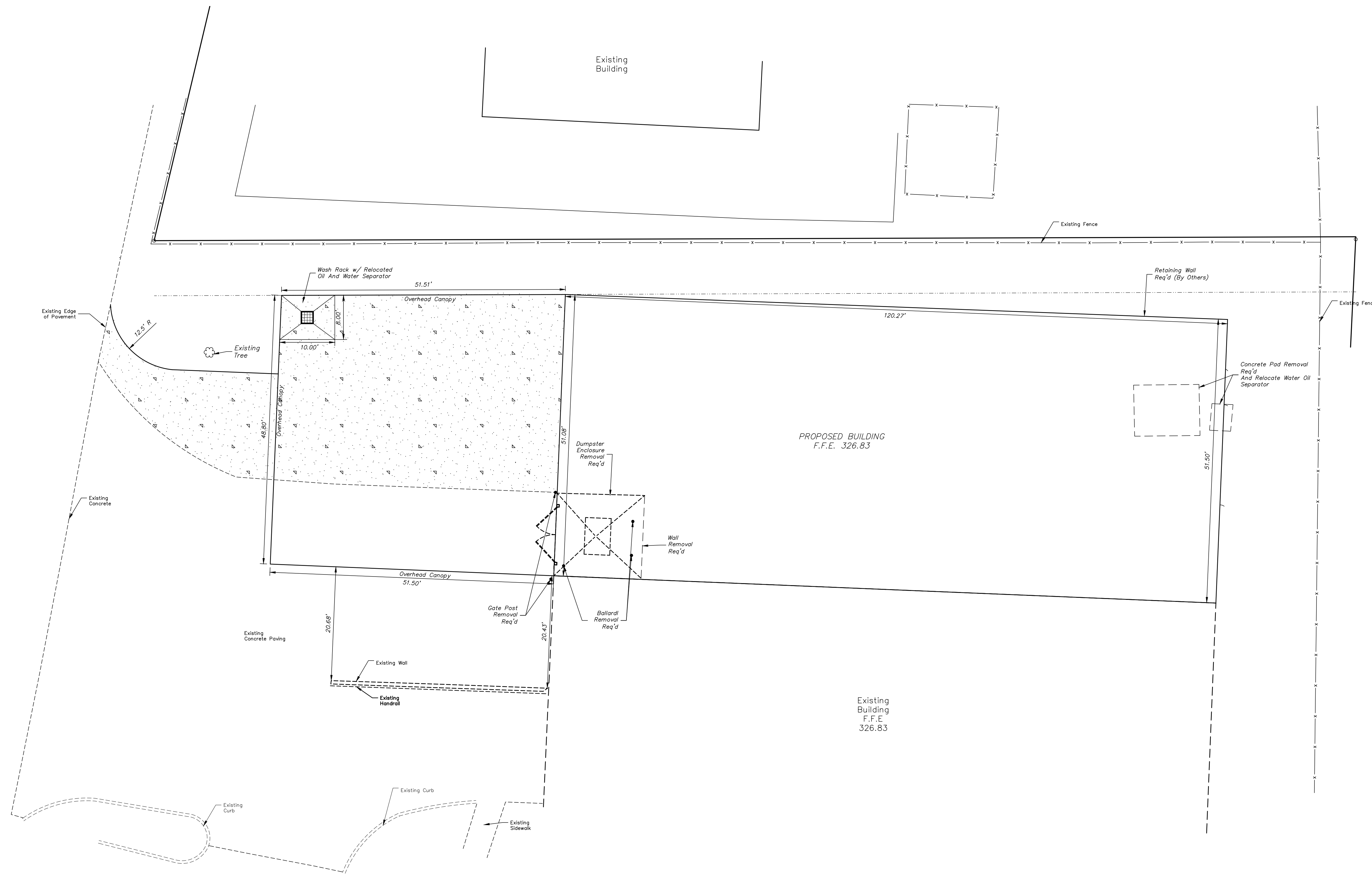

PROJECT SITE INFORMATION:
 CURRENT ZONING - C-4, HIGHWAY COMMERCIAL DISTRICT
 MINIMUM SETBACK REQUIREMENTS:
 FRONT - 30'
 SIDE - 10'
 REAR - 10'

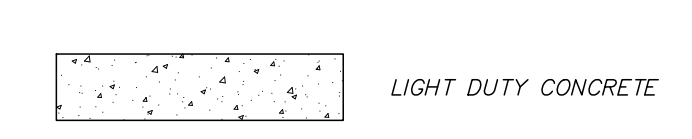

- NOTE:**
- SEE TYPICAL SECTIONS AND PROJECT SPECIFICATIONS FOR PAVING REQUIREMENTS.
 - RADIAL DIMENSIONS ARE MEASURED FROM THE BACK OF CURB.
 - PARKING LOT DIMENSIONS ARE TO THE FACE OF CURB.
 - SEE ARCHITECTURAL PLANS FOR MORE DETAILS ON THE BUILDINGS AND DUMPSTER ENCLOSURE.
 - ANY PAVING NOT DELINEATED AS A FORM OF CONCRETE OR HEAVY DUTY CONCRETE PAVING SHALL BE CONSIDERED LIGHT DUTY CONCRETE PAVING.
 - PARKING SPACE STRIPING SHALL BE 4" MINIMUM WIDTH.
 - ITEMS NOTED AS LEGEND STRIPING SHALL BE THERMOPLASTIC INSTALLED PER MDOT REQUIREMENTS FOR SIZE AND THICKNESS. ALL REMAINING STRIPING SHALL BE FAST DRYING SOLVENT BASED TRAFFIC PAINT FOR USE ON BITUMINOUS AND PORTLAND CEMENT CONCRETE PAVEMENT. PAINT SHALL MEET THE REQUIREMENTS OF SECTION 710 OF THE LATEST EDITION OF THE MISSISSIPPI STANDARD SPECIFICATIONS FOR ROAD AND BRIDGE CONSTRUCTION.
 - IT IS THE OWNER'S RESPONSIBILITY TO OBTAIN PERMISSION TO PERFORM WORK ON ADJACENT PROPERTY FROM THE PROPERTY OWNERS SHOULD IT BE NECESSARY TO COMPLETELY INSTALL IMPROVEMENTS.
 - PRIOR TO INSTALLATION OF CURB & GUTTER THE CONTRACTOR SHALL PROVIDE ENGINEER WITH A MARKED UP DRAWING SHOWING WHERE REVERSED GUTTER CURB IS PROPOSED FOR HIS REVIEW AND APPROVAL.

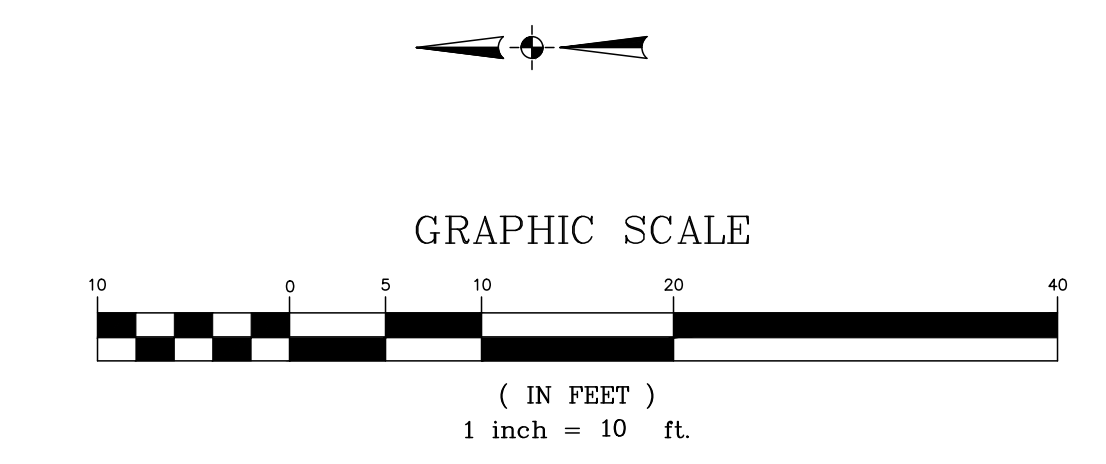

REVISIONS:

DATE	BY	DESCRIPTION
07/21/21	KOR	DRAWN
	GAB	CHECKED
		SCALE: 1"=10'
		REF C/L:
		EG SURFACE:
		FG SURFACE:

PROJECT LOCATION:
 230 US-51
 RIDGELAND, MISSISSIPPI
 CLIENT:
 GOT GEAR
 230 US-51, RIDGELAND, MS

PROJECT:
GOT GEAR ADDITION
 SHEET CONTENTS:
SITE PLAN

SHEET NUMBER
4 of 9
 PROJECT NUMBER
B-8262

DATE: 07/27/21	DRAWN: KDR	REVISIONS:
CHECKED: GAB	SCALE: 1"=10'	
REF C/L:	EG SURFACE:	
	FG SURFACE:	

PROJECT LOCATION: 230 US-51 RIDGELAND, MISSISSIPPI	CLIENT: GOT GEAR 230 US-51, RIDGELAND, MS
--	---

PROJECT: GOT GEAR ADDITION
SHEET CONTENTS: WATER & SEWER LAYOUT

SHEET NUMBER 5 of 9
PROJECT NUMBER B-8262

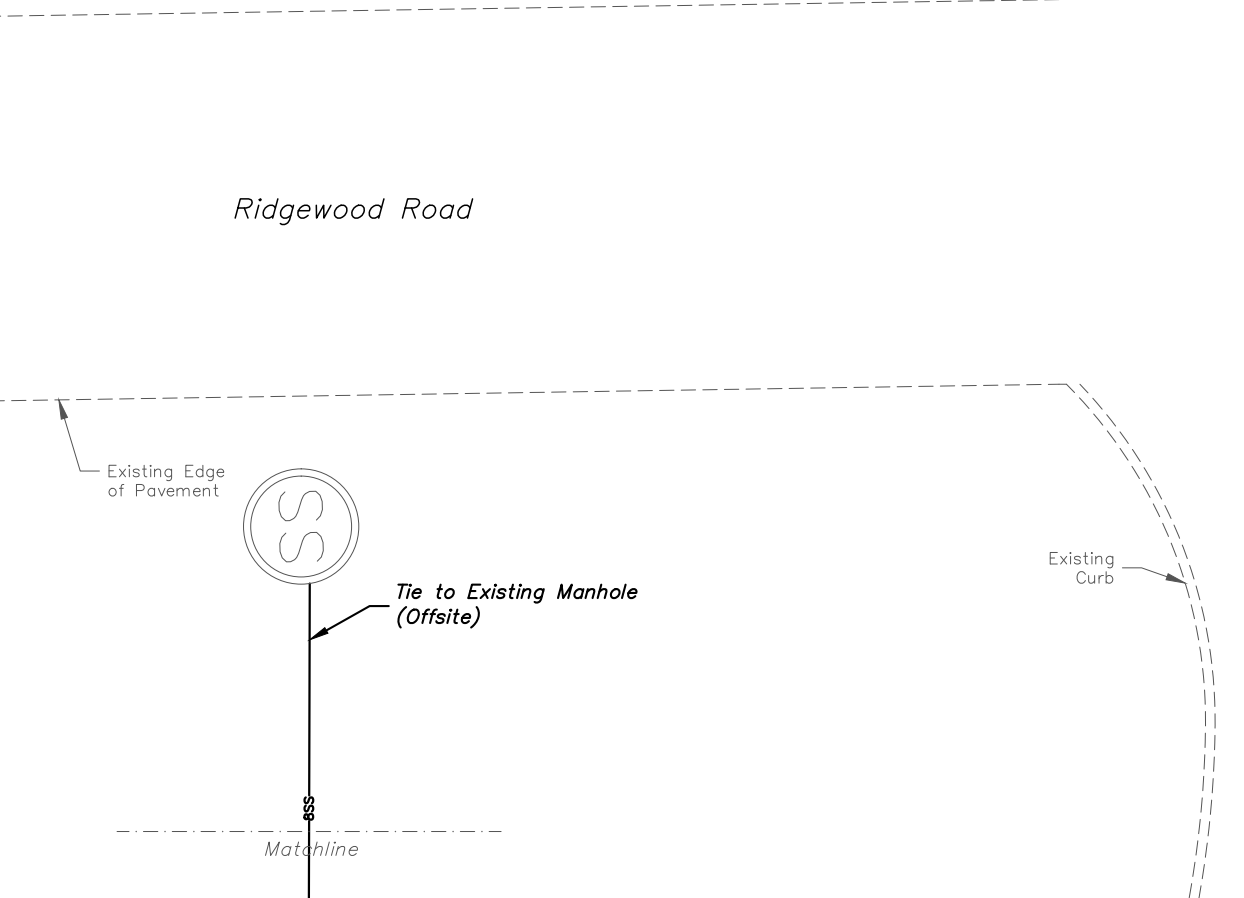
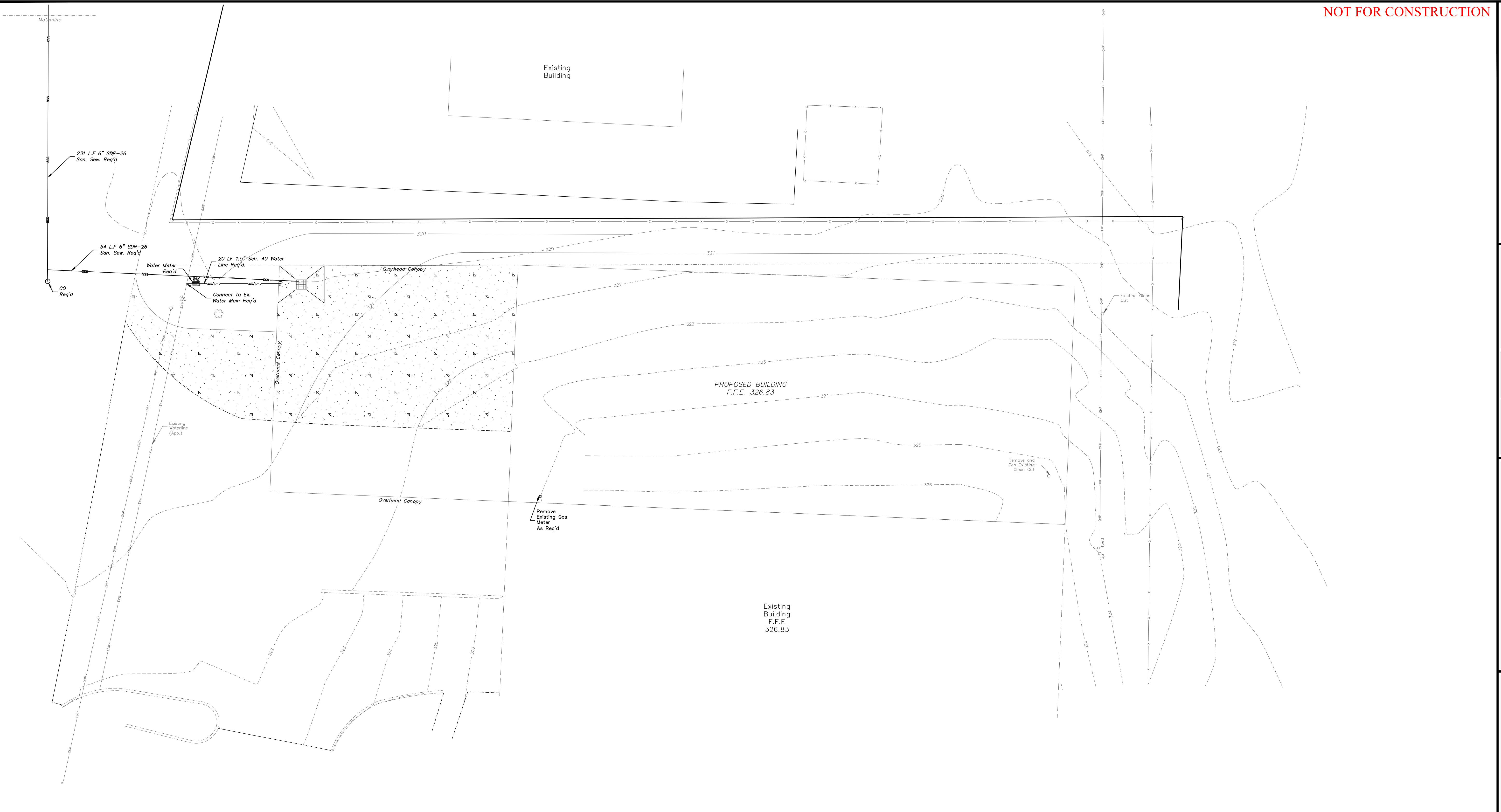

- NOTES:
- SEE NOTES ON SHEET 2, DETAIL DRAWINGS & PROJECT
 - ALL EXISTING UTILITIES ARE SHOWN AS THEY WERE MARKED BY OTHERS AND SHALL BE CONSIDERED APPROXIMATE. CONTRACTOR TO CONTACT MISSISSIPPI ONE CALL AT 811 FOR A LOCATE PRIOR TO BEGINNING CONSTRUCTION TO VERIFY LOCATIONS. CONTRACTOR SHALL POT-HOLE EXISTING UTILITY LINES IN AREAS WHERE PROPOSED UTILITIES (WATER, SEWER, STORM DRAIN) CROSS AND NOTIFY ENGINEER IMMEDIATELY IF CONFLICT IS DISCOVERED.
 - CONTRACTOR TO VERIFY EXISTING LOCATION AND ELEVATION OF ALL UTILITY INFRASTRUCTURE REQUIRED FOR COMPLETION OF THIS PROJECT IN FULL PRIOR TO BEGINNING ANY ASPECT OF CONSTRUCTION. THIS INCLUDES ALL ON-SITE AND OFF-SITE UTILITIES AS REQUIRED. SHOULD ANY DISCREPANCIES BE FOUND THEY SHALL BE IMMEDIATELY BROUGHT TO THE ENGINEER'S ATTENTION IN WRITING TO RECEIVE FURTHER INSTRUCTION.
 - CONTRACTOR SHALL COORDINATE ALL WORK DIRECTLY INVOLVING, CROSSING OR IN THE VICINITY OF AN EXISTING UTILITY LINE WITH UTILITY PROVIDER/OWNER.
 - WATER AND SANITARY SEWER LINES TO BE INSTALLED ACCORDING TO THE PROJECT DETAILS AND SPECIFICATIONS.
 - TRACER WIRE REQUIRED ON ALL NEW WATER LINES NO MATTER THE SIZE. ACCESS BOXES SHALL BE INSTALLED AS REQUIRED FOR CONTINUOUS CONDUCTIVITY IN WIRE FOR LOCATION PURPOSES AND NOTED ON THE DRAWINGS WHERE THEY WERE INSTALLED. CONTRACTOR SHALL PROVIDE ENGINEER WITH DRAWING SHOWING PROPOSED LOCATION OF ACCESS BOXES PRIOR TO INSTALLATION.
 - CONTRACTOR TO COMPARE THE PROPOSED SIZE AND PROPOSED BUILDING TIE-IN LOCATION OF ALL WATER AND SANITARY SEWER LINES WITH THE BUILDING/PLUMBING PLANS PRIOR TO CONSTRUCTION AND NOTIFY ENGINEER IN WRITING OF ANY DISCREPANCIES.
 - CONTRACTOR SHALL COORDINATE WATER SERVICE REQUIREMENTS WITH THE WATER ASSOCIATION AND PAY ALL FEES ASSOCIATED WITH SUCH.

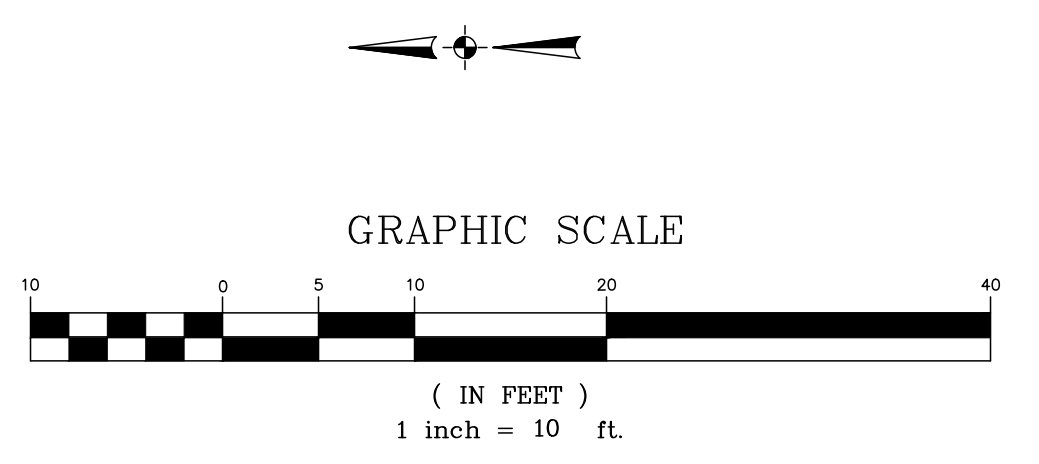

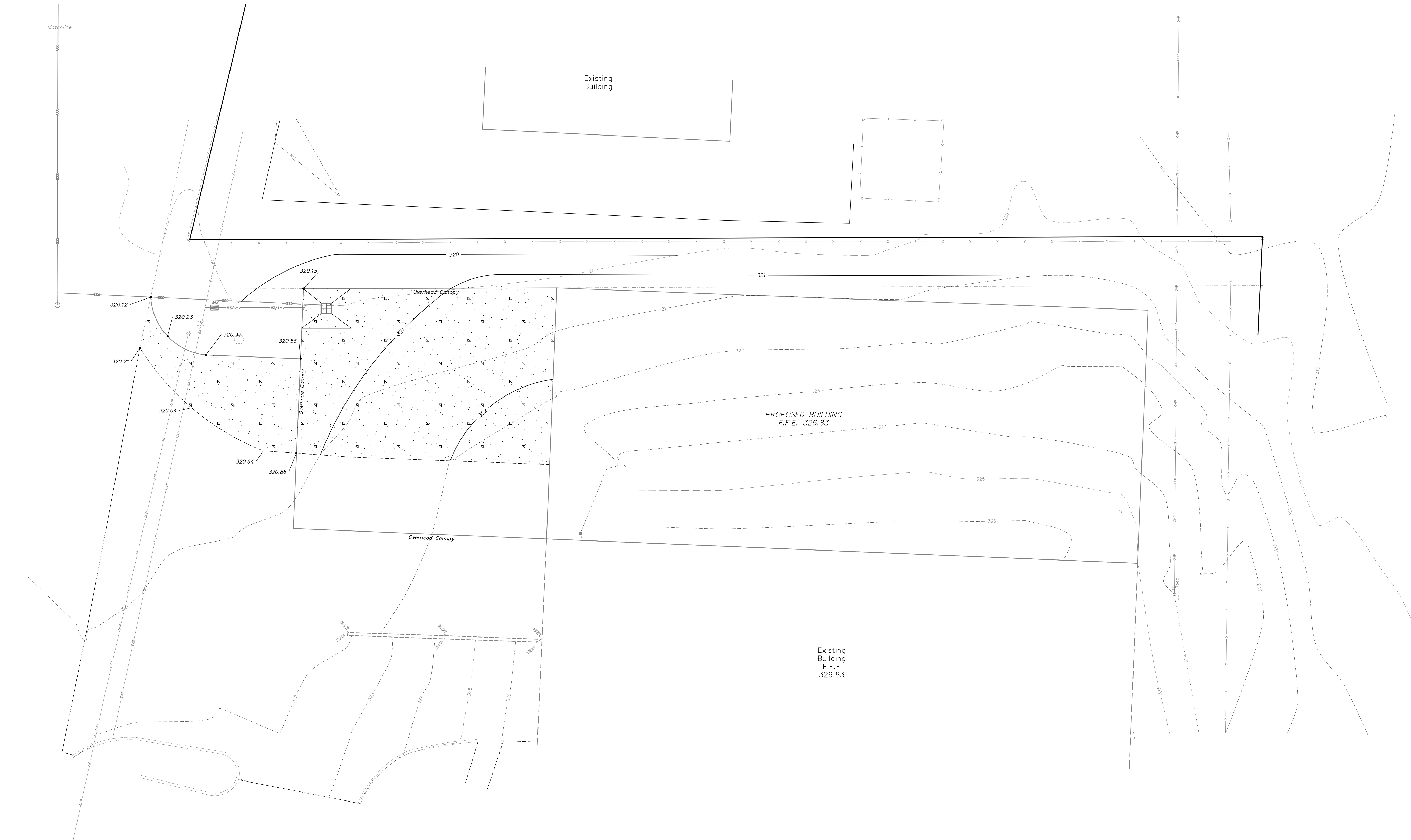

Existing Building
F.F.E
326.83

PROPOSED BUILDING
F.F.E. 326.83

- NOTES:
- SEE NOTES ON SHEET 2, DETAIL DRAWINGS & PROJECT SPECIFICATIONS FOR MORE DETAILED INFORMATION ON INSTALLATION REQUIREMENTS.
 - ALL EXISTING UTILITIES ARE SHOWN AS THEY WERE MARKED BY OTHERS AND SHALL BE CONSIDERED APPROXIMATE. CONTRACTOR TO CONTACT MISSISSIPPI ONE CALL AT 601-362-4374 FOR A LOCATE PRIOR TO BEGINNING CONSTRUCTION TO VERIFY LOCATIONS.
 - PRIOR TO BIDDING THE PROJECT THE CONTRACTOR SHALL POT-HOLE EXISTING UTILITY LINES IN AREAS WHERE PROPOSED UTILITIES (WATER, SEWER, STORM DRAIN) OR DRAINAGE SWALES ARE PROPOSED TO CROSS AND NOTIFY ENGINEER IMMEDIATELY IF CONFLICT IS DISCOVERED.
 - SLOPES THAT ARE GREATER THAN 3:1 SHALL RECEIVE SOLID SOD UNLESS OTHERWISE NOTED.
 - ALL DISTURBED AREAS THAT ARE OUTSIDE THE PROJECT SCOPE/LIMITS SHALL BE REPAIRED TO AS GOOD AS THE ORIGINAL CONDITION OR BETTER AT THE CONTRACTOR'S EXPENSE. PICTURE DOCUMENTATION OF THESE AREAS SHALL BE PROVIDED BY THE CONTRACTOR PRIOR TO DISTURBING TO SERVE AS PROOF OF THE PRE-EXISTING CONDITION.

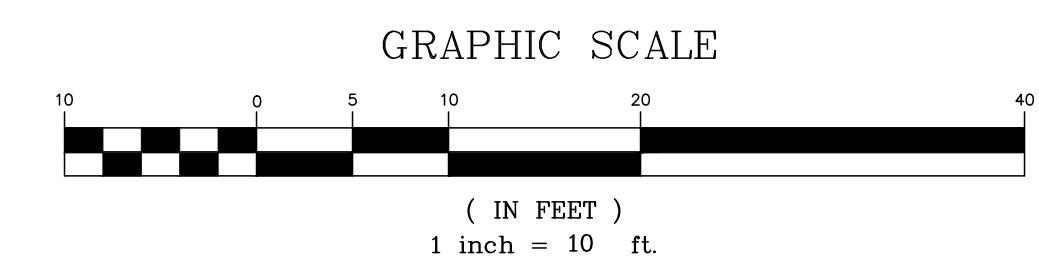
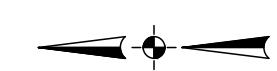

BENCHMARK
ENGINEERING & SURVEYING, LLC
101 Highpointe Court, Suite B
Flowood, Mississippi 39242
Phone: 601-827-7100
www.benchmarkms.net

DATE: 07/21/21	DRAWN: KDR	REVISIONS:
CHECKED: GAB	SCALE: 1"=10'	
REF C/L:	EG SURFACE:	
	FG SURFACE:	

PROJECT LOCATION:
230 US-51
RIDGELAND, MISSISSIPPI

CLIENT:
GOT GEAR
230 US-51, RIDGELAND, MS

PROJECT:
GOT GEAR ADDITION

SHEET CONTENTS:
GRADING PLAN

SHEET NUMBER
6 of 9

PROJECT NUMBER
B-8262

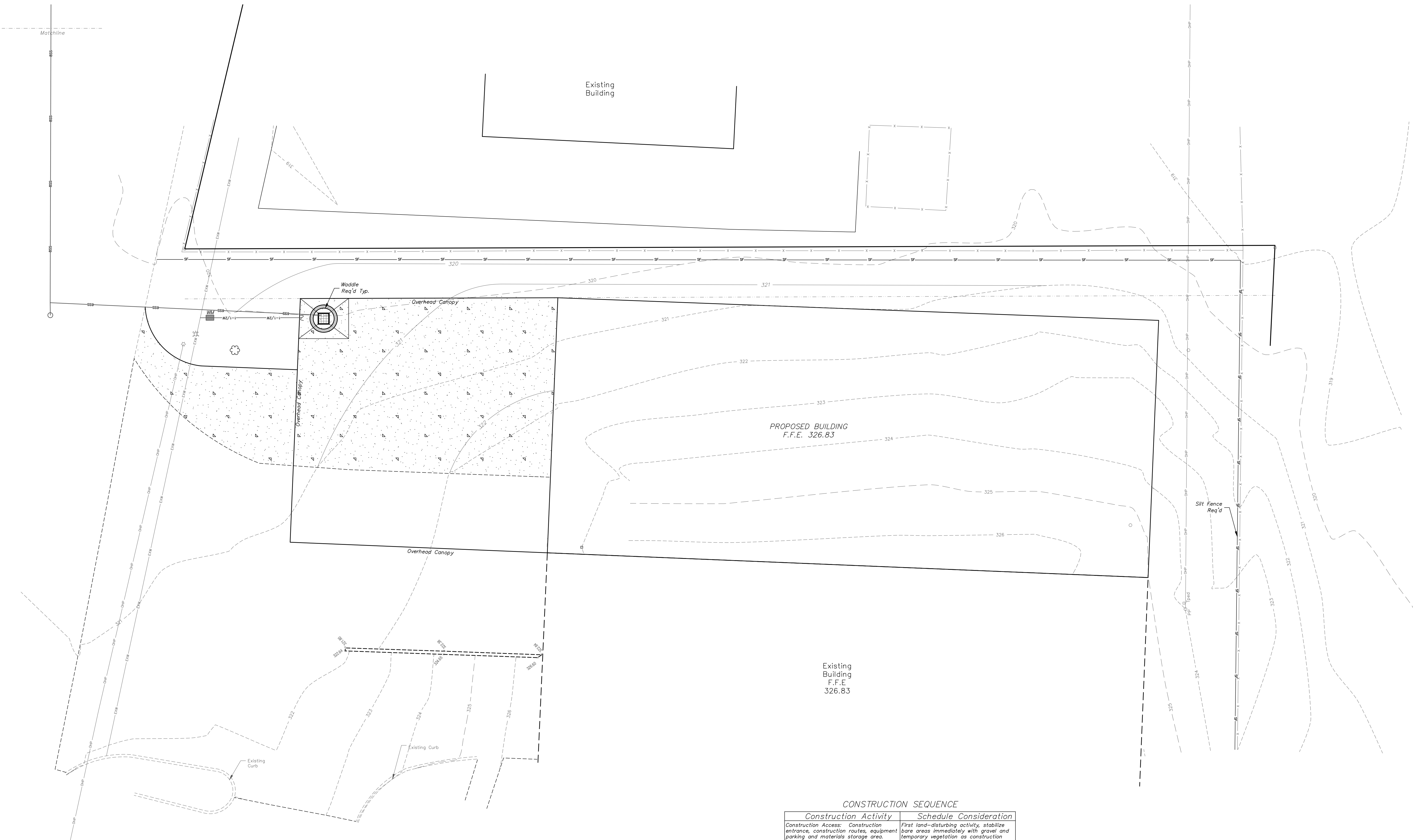

EROSION CONTROL NOTES:

- ALL DISTURBED AREAS SHALL BE TREATED WITH PERMANENT SEED & MULCH ONCE SUCH HAS REACHED FINAL GRADE. IT IS INTENDED THAT COMMON BERMUDA BE THE SPECIES PLANTED FOR THIS PURPOSE. SHOULD THE CONSTRUCTION SCHEDULE NOT BE CONDUCTIVE TO PLANTING BERMUDA PER SPECIFICATIONS, THEN THE CONTRACTOR SHALL SUBMIT AN ALTERNATE SPECIES FOR APPROVAL.
- IT IS THE CONTRACTOR'S RESPONSIBILITY TO OBTAIN A COPY OF THE SMALL CONSTRUCTION NOTICE OF INTENT (SCNOI) AND FILL IN THE PRIME CONTRACTOR'S INFORMATION AND SEND IN TO MDEQ AND PROVIDE A COPY TO ENGINEER. A COPY OF THE SCNOI MUST BE KEPT READILY AVAILABLE AT THE JOB SITE. ALL REQUIREMENTS OF THE SCNOI ARE THE CONTRACTOR'S RESPONSIBILITY INCLUDING BUT NOT LIMITED TO ALL REQUIRED INSPECTIONS, WEEKLY REPORTS AND MAINTENANCE OF THE SITE.
- S.C.N.O.I. COVERAGE SHALL BE TRANSFERRED TO SITE PROJECT CONTRACTOR ONCE PROJECT IS AWARDED. SUCH COVERAGE SHALL THEN BE TRANSFERRED TO GENERAL CONTRACTOR ONCE SITE PACKAGE REQUIREMENTS HAVE BEEN COMPLETED. THIS IS THE CONTRACTOR'S RESPONSIBILITY AND COPIES OF SUCH SHALL BE PROVIDED TO ENGINEER AND OWNER.
- EROSION AND SEDIMENT CONTROL MEASURES ARE TO BE IMPLEMENTED PRIOR TO STARTING ANY CONSTRUCTION ACTIVITIES THAT DISTURB EXISTING GROUND.
- CONTRACTOR IS TO EVALUATE ALL STORM WATER MANAGEMENT CONTROLS A MINIMUM OF ONCE PER WEEK AND AFTER RAINFALL EVENTS TO DETERMINE EFFECTIVENESS OF THE EROSION AND SILTATION CONTROL MEASURES. ADDITIONAL MEASURES TO BE INSTALLED AS NEEDED TO CONTROL SEDIMENT (ABSORBED). INSPECTION REPORTS TO BE FILLED OUT ONCE PER WEEK NOTING ALL ACTIONS (IF ANY) REQUIRED.
- IT IS THE CONTRACTOR'S RESPONSIBILITY TO MAINTAIN AND REPAIR ALL TEMPORARY EROSION CONTROL MEASURES THROUGHOUT CONSTRUCTION. NO SEPARATE PAYMENT SHALL BE MADE FOR MAINTENANCE OR REPLACEMENT OF ANY TEMPORARY EROSION CONTROL MEASURES.
- TEMPORARY EROSION CONTROL MEASURES DEPICTED ON THIS DRAWING ARE MINIMUM REQUIREMENTS TO BE UTILIZED IN DEVELOPMENT OF THE SITE-SPECIFIC STORMWATER POLLUTION PREVENTION PLAN AND ARE NOT MEANT TO ADDRESS ALL OF THE REQUIREMENTS OF THE CONSTRUCTION GENERAL PERMIT.
- IT IS THE INTENT OF THE SPECIFICATIONS THAT THE WORK SHALL PROCEED IN A MANNER AND SEQUENCE TO ENSURE THAT ESTABLISHMENT OF PERMANENT EROSION CONTROL ITEMS ARE ACCOMPLISHED IMMEDIATELY AFTER FINISH GRADING.
- EFFECTIVE USE OF TEMPORARY MEASURES, INCLUDING SEDIMENT BASINS, TEMPORARY SEEDING, ETC. SHALL BE MADE SO AS TO PREVENT OR MINIMIZE EROSION AND SILTATION UNTIL PERMANENT MEASURES ARE ESTABLISHED.
- CONTRACTOR TO CONTACT MISSISSIPPI ONE CALL @ 811 AT LEAST 48 HOURS BEFORE IMPROVEMENTS ARE MADE.
- CONTRACTOR SHALL BE REQUIRED TO FURNISH ALL MATERIALS AND PERFORM ALL WORK FOR THE PROPER INSTALLATION, MAINTENANCE, AND REMOVAL OF TEMPORARY EROSION CONTROL MEASURES TO CONTROL SILTATION.
- SEE THE EROSION CONTROL DETAIL SHEET FOR MORE DETAIL ON THE INSTALLATION OF THE REQUIRED EROSION CONTROL MEASURES.
- ONCE THE PERMANENT EROSION CONTROL MEASURES ARE IN PLACE A FINAL SITE INSPECTION IS TO BE COORDINATED BY THE CONTRACTOR WITH THE ENGINEER AND THE OWNER. ONCE SITE MEETS ALL PARTIES SPECIFICATIONS THE CONTRACTOR WITH BE RELIEVED OF THE RESPONSIBILITIES OF THIS CONTRACT.
- IT IS THE CONTRACTOR'S RESPONSIBILITY TO ENSURE THAT THE EROSION CONTROL MEASURES SHOULD, TO THE EXTENT PRACTICABLE:
 - DIVERT UP-SLOPE WATER AROUND DISTURBED AREAS OF THE SITE
 - LIMIT THE EXPOSURE OF DISTURBED AREAS TO THE SHORTEST AMOUNT OF TIME POSSIBLE
 - MINIMIZE THE AMOUNT OF SURFACE AREA THAT MUST BE DISTURBED
 - IMPLEMENT BEST MANAGEMENT PRACTICES TO MITIGATE ADVERSE IMPACTS FROM STORM WATER RUNOFF
 - REMOVE SEDIMENT THAT WOULD CONTRIBUTE TO OR CAUSE ADVERSE IMPACTS TO STATE WATERS FROM STORM WATER BEFORE IT LEAVES THE SITE

CONSTRUCTION SEQUENCE

Construction Activity	Schedule Consideration
Construction Access: Construction entrance, construction routes, equipment parking and materials storage area.	First land-disturbing activity, stabilize bare areas immediately with gravel and temporary vegetation as construction takes place, construct equipment and materials staging area. Install temporary sanitary facilities & trash containers.
Sediment Traps and Barriers: Sediment fences, straw bale barriers, inlet protection & sediment basins.	Install principal basins after construction site is accessed. Install additional traps and barriers as needed during grading.
Runoff Control: Diversion, water bars, and outlet protection.	Install key practices after principal sediment traps and before land grading. Install additional runoff-control measures during grading.
Runoff Conveyance System: Stabilize stream banks, storm drains, channels, inlet and outlet protection, slope drains.	Where necessary, stabilize stream banks as early as possible. Install principal runoff conveyance with runoff control measures. Install remainder of system after grading.
Land Clearing and Grading: Site preparation, cutting, filling and grading, sediment basins, barriers, diversions, drains, surface roughening.	Begin major clearing and grading after principal sediment and key runoff control measures are installed. Clear borrow and disposal areas only as needed. Install additional control measures as grading progressed. Don't allow equipment or personnel within drip line of marked trees.
Surface Stabilization: Temporary and permanent seeding, mulching, sodding, and rip-rap.	Apply temporary or permanent stabilization measures immediately on all disturbed areas where work is delayed or complete.
Building Construction: Buildings, utilities, paving.	Install necessary erosion and sedimentation control practices as work takes place. Install a sealable materials storage container in staging area. Construct a temporary concrete washout area.
Landscaping and Final Stabilization: Top soiling, trees and shrubs, permanent seeding, mulching, sodding, rip-rap.	Last construction phase - remove temporary concrete washout area, stabilize all open areas, including borrow and spoil areas. Remove and stabilize all temporary control measures.

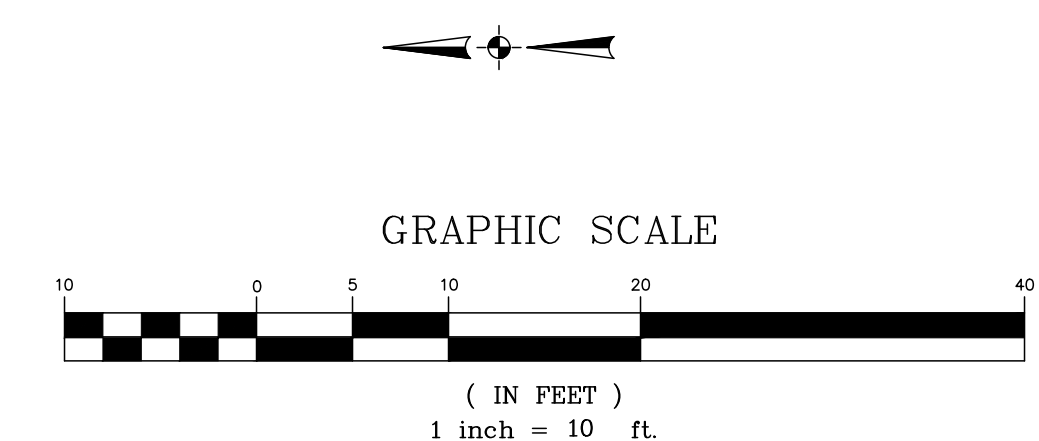

DATE: 07/27/21 DRAWN: KDR
 CHECKED: CAB SCALE: 1"=10'
 REF C/L:
 EC SURFACE:
 FG SURFACE:

PROJECT LOCATION:
 230 US-51
 RIDGELAND, MISSISSIPPI
 CLIENT:
 GOT GEAR
 230 US-51, RIDGELAND, MS

PROJECT:
 GOT GEAR ADDITION
 SHEET CONTENTS:
 EROSION CONTROL PLAN

SHEET NUMBER
 7 of 9
 PROJECT NUMBER
 B-8262

DATE: 07/27/21	DRAWN: KDR	REVISIONS:
CHECKED: GAB	SCALE: 1"=10'	
REF C/L:	EG SURFACE:	
	FG SURFACE:	

PROJECT LOCATION: 230 US-51 RIDGELAND, MISSISSIPPI
CLIENT: GOT GEAR 230 US-51, RIDGELAND, MS

PROJECT: GOT GEAR ADDITION
SHEET CONTENTS: WATER & SEWER LAYOUT

SHEET NUMBER 5 of 9
PROJECT NUMBER B-8262

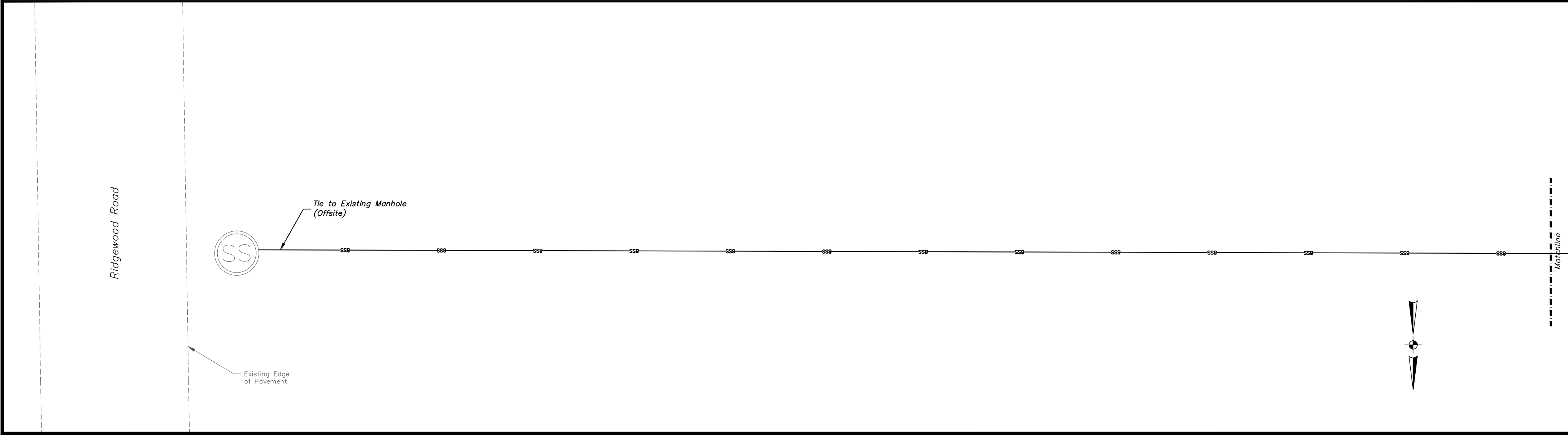
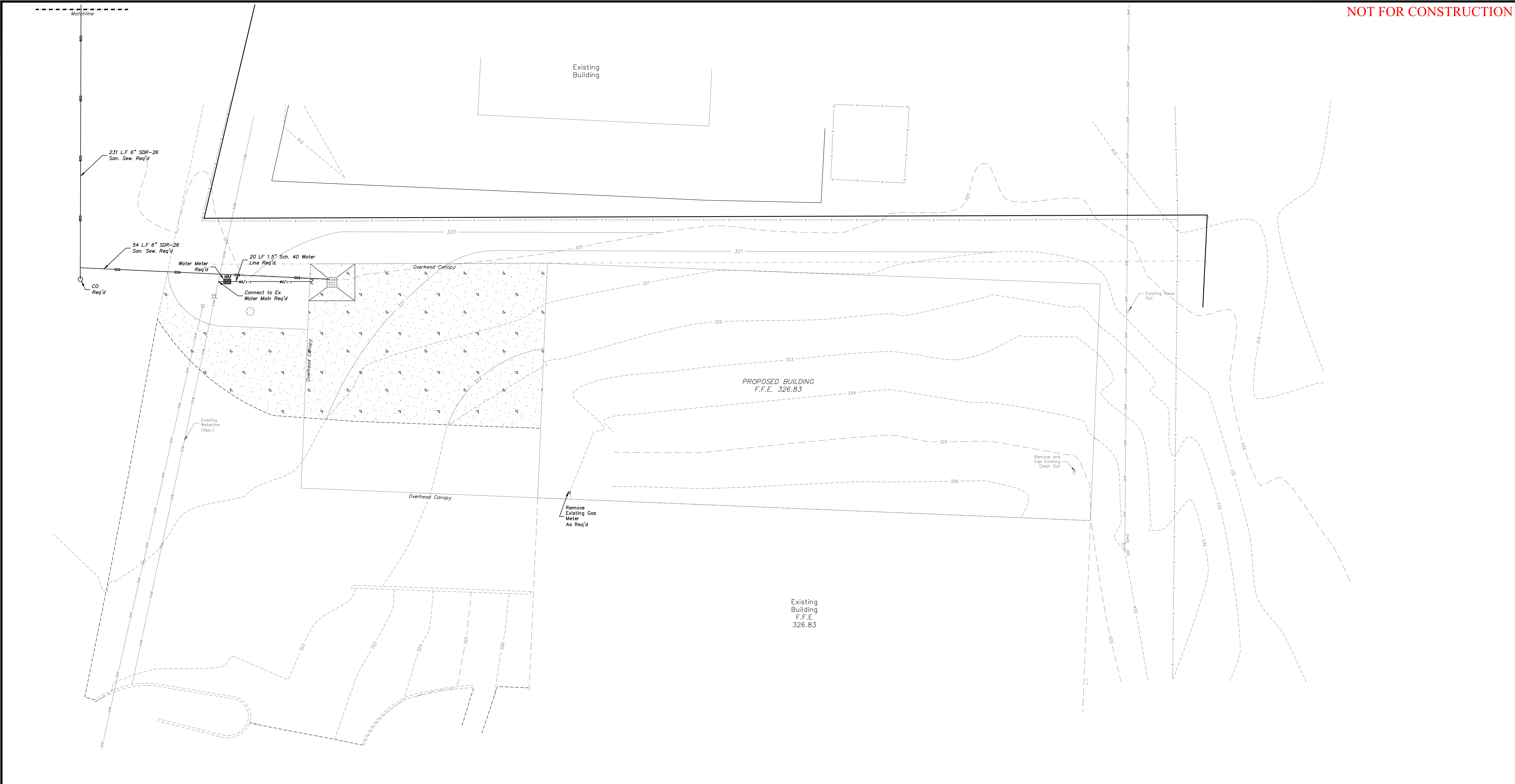

NOTES:

- SEE NOTES ON SHEET 2, DETAIL DRAWINGS & PROJECT
- ALL EXISTING UTILITIES ARE SHOWN AS THEY WERE MARKED BY OTHERS AND SHALL BE CONSIDERED APPROXIMATE. CONTRACTOR TO CONTACT MISSISSIPPI ONE CALL AT 811 FOR A LOCATE PRIOR TO BEGINNING CONSTRUCTION TO VERIFY LOCATIONS. CONTRACTOR SHALL POT-HOLE EXISTING UTILITY LINES IN AREAS WHERE PROPOSED UTILITIES (WATER, SEWER, STORM DRAIN) CROSS AND NOTIFY ENGINEER IMMEDIATELY IF CONFLICT IS DISCOVERED.
- CONTRACTOR TO VERIFY EXISTING LOCATION AND ELEVATION OF ALL UTILITY INFRASTRUCTURE REQUIRED FOR COMPLETION OF THIS PROJECT IN FULL PRIOR TO BEGINNING ANY ASPECT OF CONSTRUCTION. THIS INCLUDES ALL ON-SITE AND OFF-SITE UTILITIES AS REQUIRED. SHOULD ANY DISCREPANCIES BE FOUND THEY SHALL BE IMMEDIATELY BROUGHT TO THE ENGINEER'S ATTENTION IN WRITING TO RECEIVE FURTHER INSTRUCTION.
- CONTRACTOR SHALL COORDINATE ALL WORK DIRECTLY INVOLVING CROSSING OR IN THE VICINITY OF AN EXISTING UTILITY LINE WITH UTILITY PROVIDER/OWNER.
- WATER AND SANITARY SEWER LINES TO BE INSTALLED ACCORDING TO THE PROJECT DETAILS AND SPECIFICATIONS.
- TRACER WIRE REQUIRED ON ALL NEW WATER LINES NO MATTER THE SIZE. ACCESS BOXES SHALL BE INSTALLED AS REQUIRED FOR CONTINUOUS CONDUCTIVITY IN WIRE FOR LOCATION PURPOSES AND NOTED ON THE DRAWINGS WHERE THEY WERE INSTALLED. CONTRACTOR SHALL PROVIDE ENGINEER WITH DRAWING SHOWING PROPOSED LOCATION OF ACCESS BOXES PRIOR TO INSTALLATION.
- CONTRACTOR TO COMPARE THE PROPOSED SIZE AND PROPOSED BUILDING TIE-IN LOCATION OF ALL WATER AND SANITARY SEWER LINES WITH THE BUILDING/PLUMBING PLANS PRIOR TO CONSTRUCTION AND NOTIFY ENGINEER IN WRITING OF ANY DISCREPANCIES.
- CONTRACTOR SHALL COORDINATE WATER SERVICE REQUIREMENTS WITH THE WATER ASSOCIATION AND PAY ALL FEES ASSOCIATED WITH SUCH.

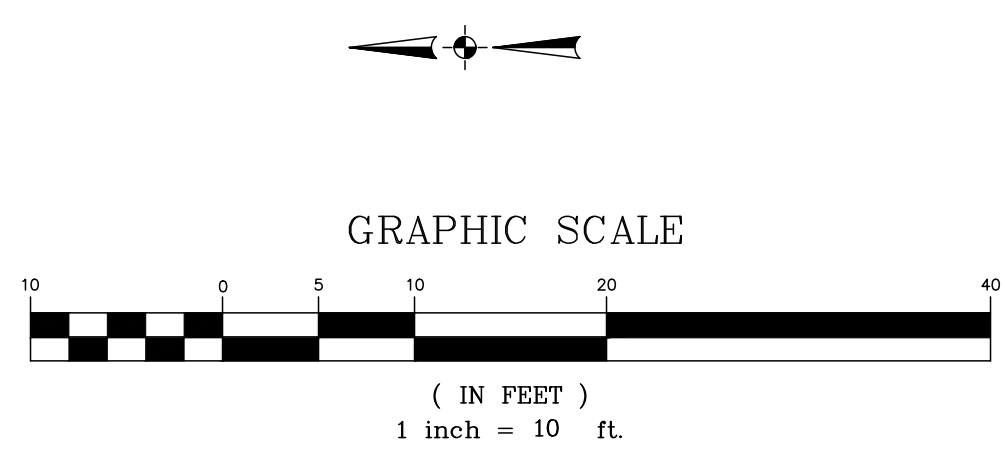

Species	Seeding Rate/Ac	Planting Time	Desired pH Range	Fertilization Rate/Ac	Method of Establishing
Common Bermuda	15 lbs. alone 10 lbs. mixture	Mar 1 - July 15 Sept 1 - Nov 30	6.0 - 7.0	600 lbs. 13-13-13	Seed
Bahia	40 lbs. alone 30 lbs. mixture	Mar 1 - July 15 Sept 1 - Nov 30	6.0 - 7.0	600 lbs. 13-13-13	Seed
Fescue	40 lbs. alone 30 lbs. mixture	Sept 1 - Nov 30	6.0 - 7.0	600 lbs. 13-13-13	Seed
Sericea Lespedeza	40 lbs. alone	Mar 1 - July 15 Sept 1 - Nov 30	6.0 - 7.0	400 lbs. 6-24-24	Seed
*Wheat	90 lbs.	Sept 1 - Nov 30	6.0 - 7.0	600 lbs. 13-13-13	Seed
*Ryegrass	30 lbs.	Sept 1 - Nov 30	6.0 - 7.0	600 lbs. 13-13-13	Seed
*White Clover	5 lbs.	Sept 1 - Nov 30	6.0 - 7.0	400 lbs. 6-24-24	Seed
*Crimson Clover	15 lbs.	Sept 1 - Nov 30	6.0 - 7.0	400 lbs. 6-24-24	Seed
*Hoary Vetch	30 lbs.	Sept 1 - Nov 30	6.0 - 7.0	400 lbs. 6-24-24	Seed
*Browntop Millet	40 lbs. alone 15 lbs. mixture	Apr 1 - Aug 30	6.0 - 7.0	600 lbs. 13-13-13	Seed
*ANNUAL					

NOTES:
 1. FOR PERMANENT SEEDING, ANNUALS CAN ONLY BE USED IN A MIXTURE WITH PERENNIALS.
 2. SPECIES THAT ARE TO BE SPREAD AS SOLID SOD ARE NOT LISTED (i.e. ST. AUGUSTINE, CENTIPEDE, CARPET GRASS, & ZOYSIA).
 3. DURING THE MONTHS OF DECEMBER THROUGH FEBRUARY MULCHING IS THE ONLY OPTION ALLOWED.

GENERAL RECOMMENDATIONS FOR TEMPORARY/PERMANENT SEEDING

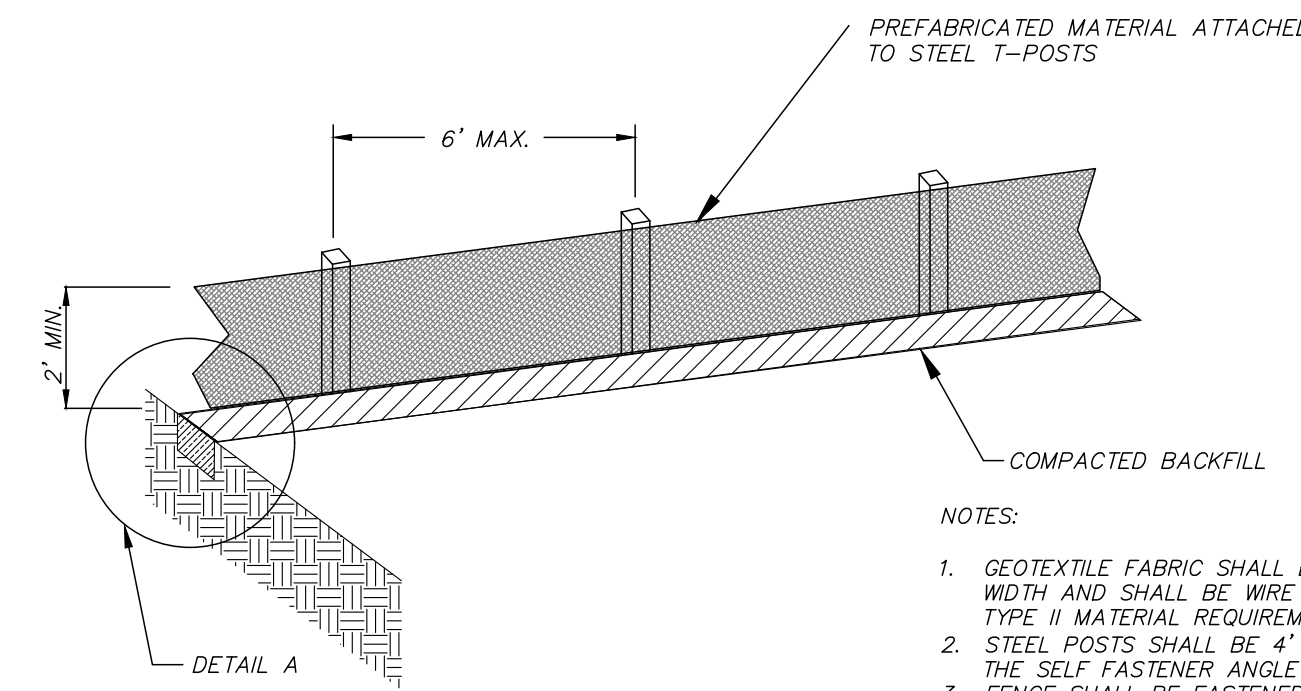

SILT FENCE DETAIL

- NOTES:
 1. GEOTEXTILE FABRIC SHALL BE A MINIMUM OF 36" IN WIDTH AND SHALL BE WIRE BACKED OR MEET MDOT TYPE II MATERIAL REQUIREMENTS.
 2. STEEL POSTS SHALL BE 4" (MIN.) IN HEIGHT AND OF THE SELF FASTENER ANGLE STEEL TYPE.
 3. FENCE SHALL BE FASTENED WITH NOT LESS THAN 9 GAGE STAPLES 1" LONG FOR WOODEN POSTS AND 3/4" FOR WOODEN STAKES.
 4. ALLOW A 6" OVERLAP OF FABRIC AT JOINTS.

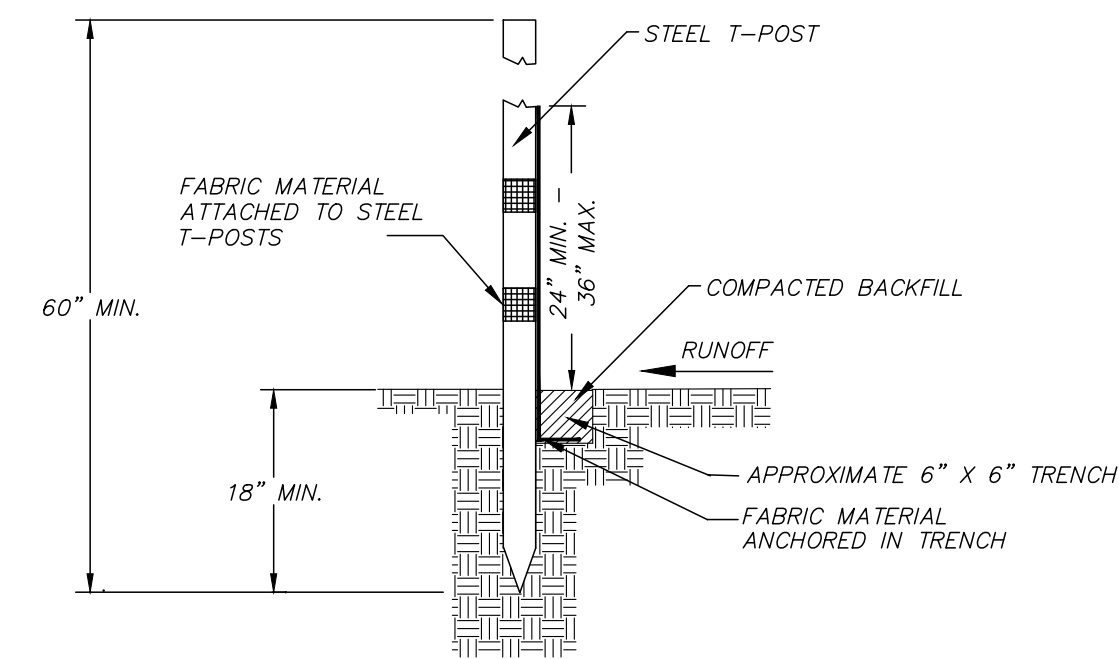

SILT FENCE DETAILS

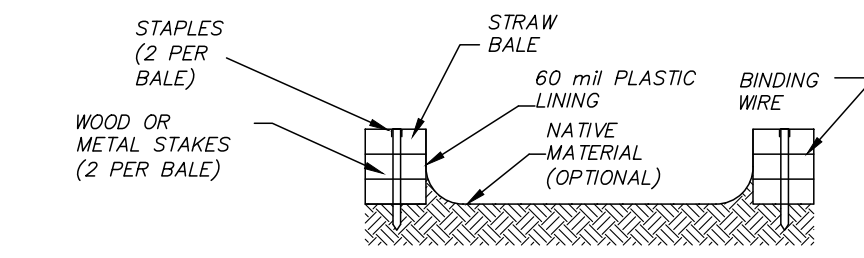

SECTION B-B

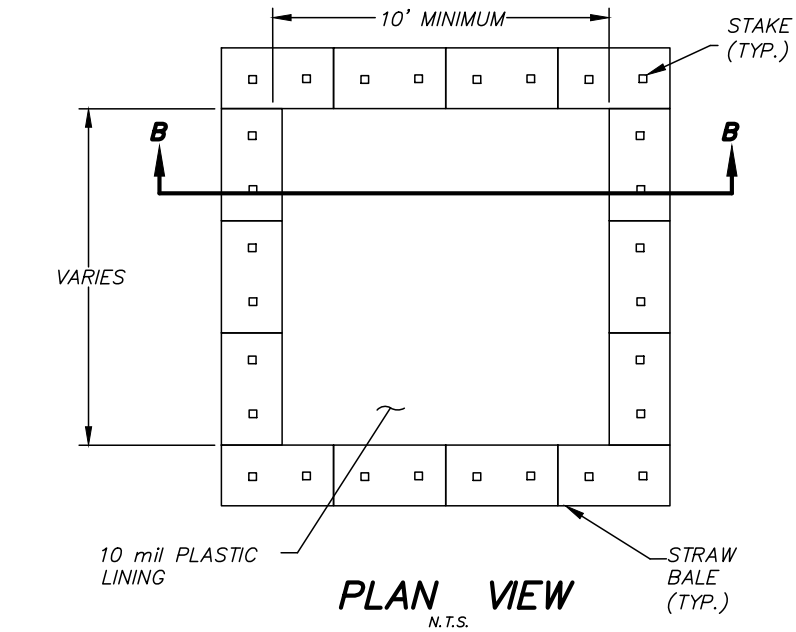

STRAW BALE CONCRETE WASHOUT AREA

- NOTES:
 1. LOCATION TO BE DETERMINED BY CONTRACTOR AND APPROVED BY THE ENGINEER OR ENGINEER'S REPRESENTATIVE.
 2. IF CONCRETE WASHOUT AREA EXHIBITS LEAKAGE OR PROVES TO BE INADEQUATE FOR ITS INTENDED PURPOSE, THE CONTRACTOR SHALL IMMEDIATELY REPAIR OR REPLACE.
 3. IF REQUIRED BY ENGINEER OR C.O.D.L. AREAS IMMEDIATELY DOWNSTREAM/DOWNSLOPE SHALL INCLUDE A SECONDARY STORMWATER RUNOFF POLLUTION PREVENTION MEASURE.
 4. MAINTENANCE SHALL BE IN ACCORDANCE WITH THE APPROVED STORMWATER MANAGEMENT PLAN.

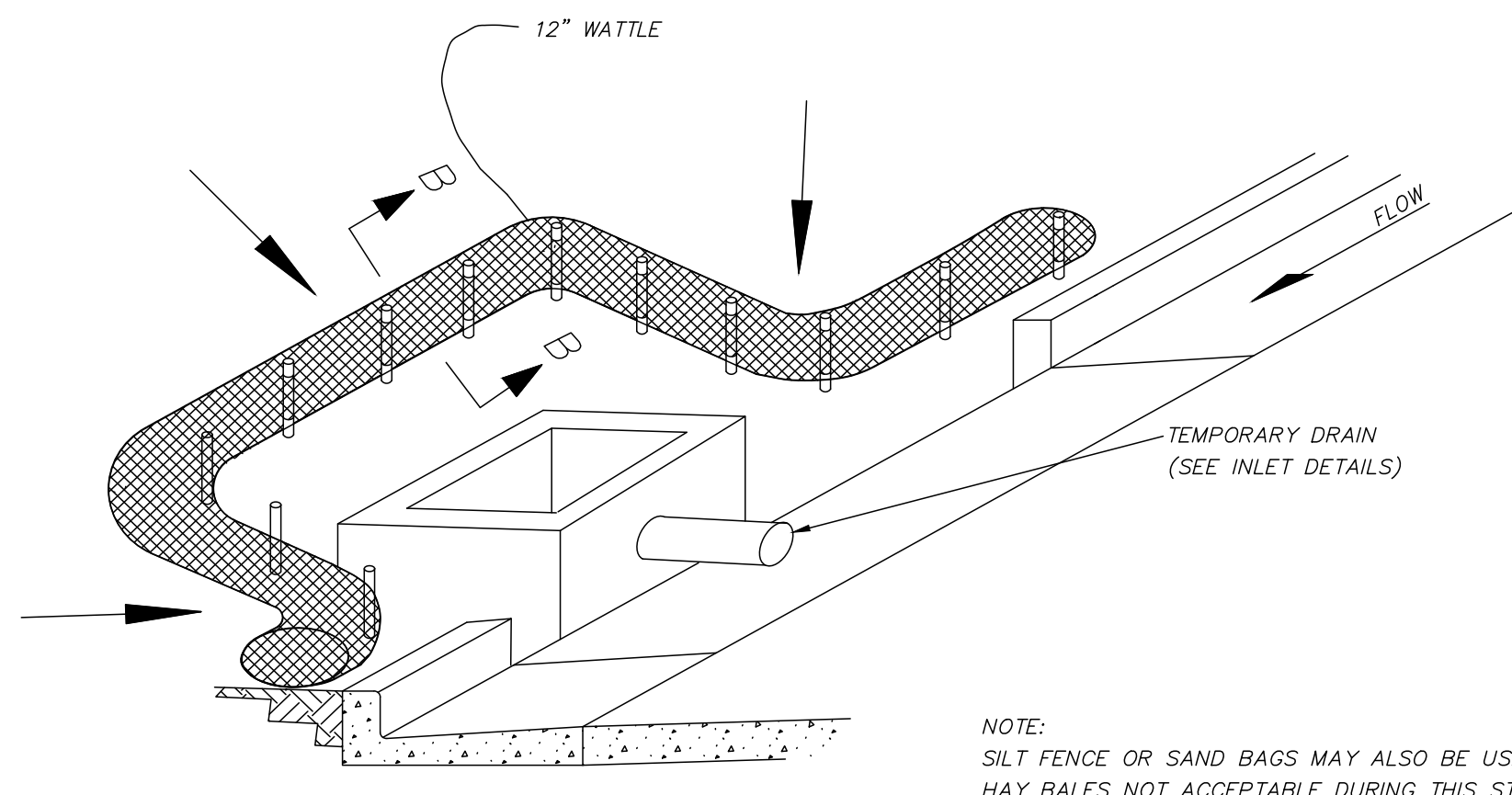

CURB INLET PROTECTION
SINGLE OR DOUBLE WING INLET

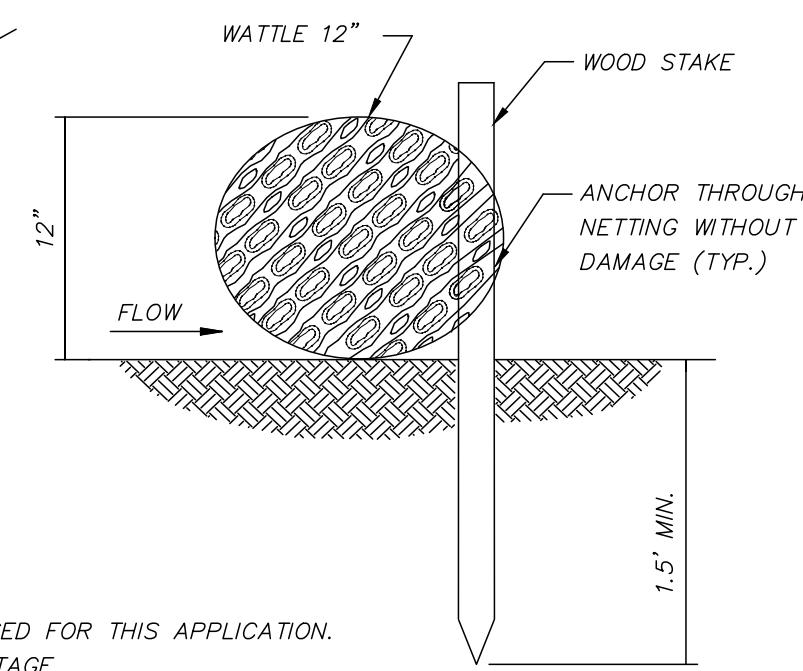

SECTION B-B

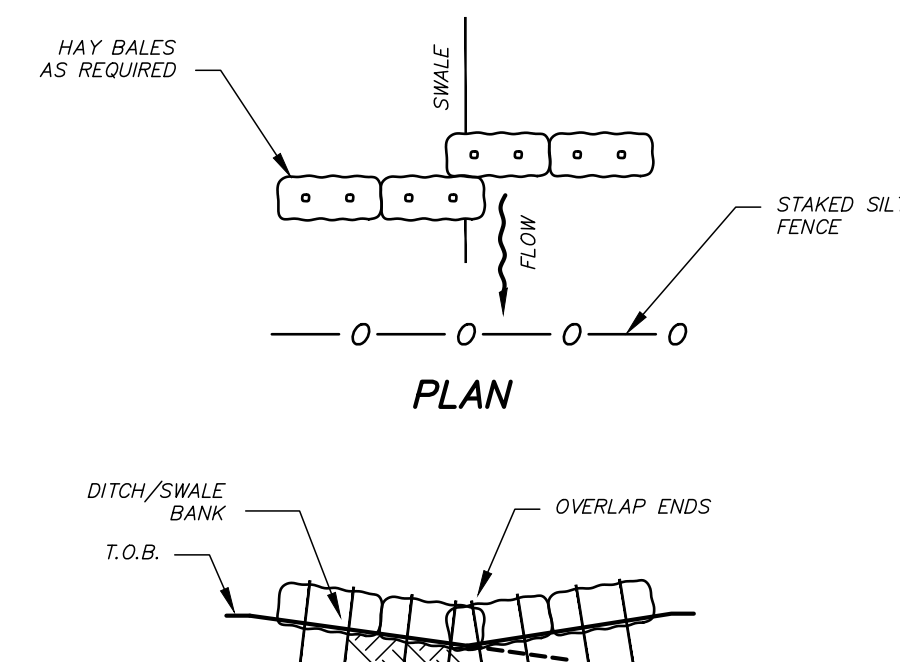

ELEVATION

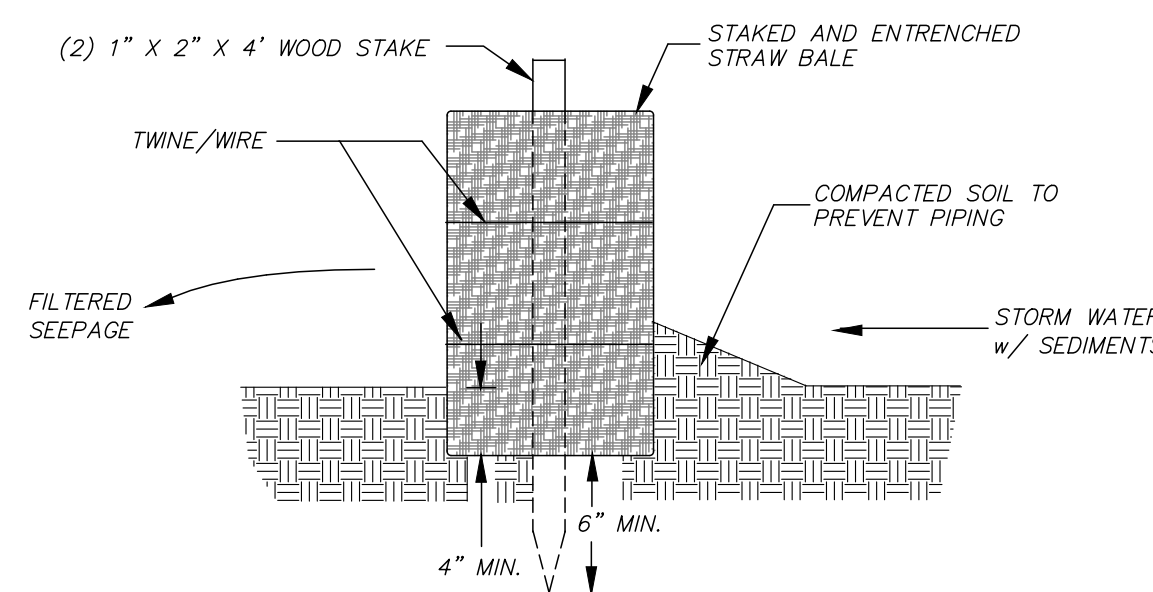

- HAY BALE INSTALLATION NOTES:
 1. HAY BALES SHALL BE TRENCHED 3" TO 4" AND STAKED WITH (2) 1"x2"x4" WOOD STAKES PER BALE.
 2. SILT FENCE SHALL BE DOWN STREAM OF HAY BALES.
 3. ADJACENT BALES SHALL BE BUTTED FIRMLY TOGETHER. UNAVOIDABLE GAPS SHALL BE PLUGGED WITH HAY OR STRAW TO PREVENT SILT FROM PASSING.

HAY BALE INSTALLATION

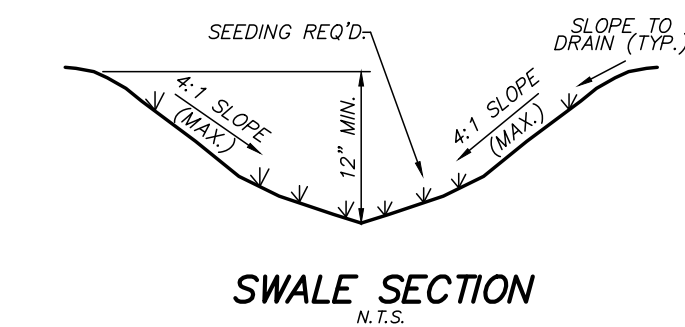

SWALE SECTION

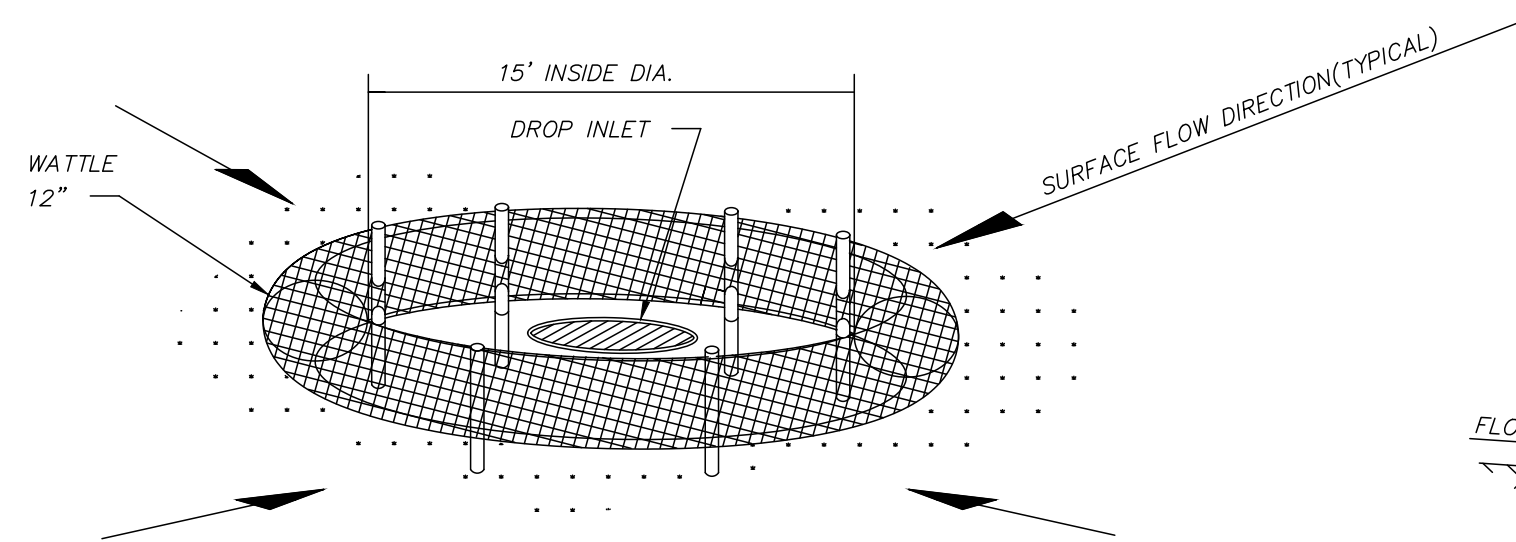

DROP INLET PROTECTION

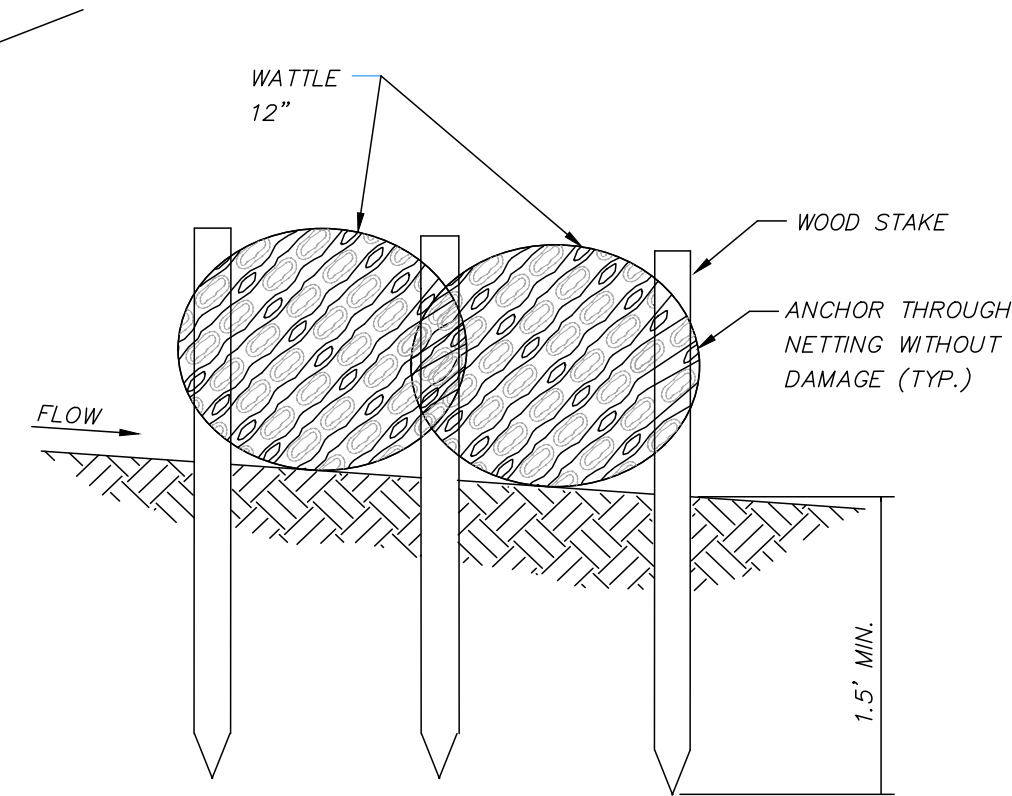

SECTION A-A

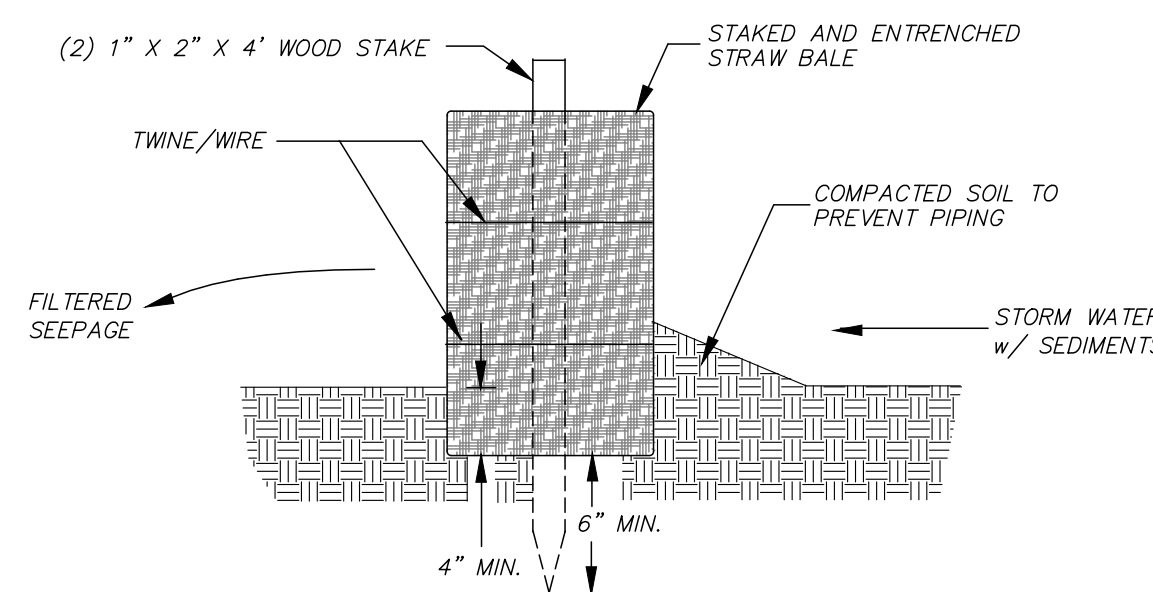

- NOTES:
 1. VEHICLE TRACKING MAT SHALL BE LOCATED AT EVERY ENTRANCE/EXIT TO THE CONSTRUCTION SITE.
 2. VEHICLE TRACKING MAT SHALL BE MAINTAINED BY CONTRACTOR AS NEEDED TO PREVENT ANY MATERIAL FROM BEING TRACKED ONTO CITY STREET.
 3. SEDIMENT AND OTHER MATERIAL SPILLED, DROPPED OR TRACKED ONTO CITY STREET SHALL BE IMMEDIATELY REMOVED BY CONTRACTOR.
 4. DIMENSIONS SHOWN ABOVE ARE TYPICAL IF CONDITIONS ALLOW. ANY REVISIONS TO DIMENSIONS SHALL BE APPROVED BY ENGINEER PRIOR TO INSTALLATION.

TEMPORARY CONSTRUCTION ENTRANCE DETAIL

WATTLE INLET PROTECTION

DATE: 07/18/21	REVISIONS:
CHECKED: GAB	DRAWN: KDR
REF C/L:	SCALE:
EG SURFACE:	FG SURFACE:

PROJECT LOCATION:
 230 US-51
 RIDGELAND, MISSISSIPPI
 CLIENT:
 GOT GEAR
 230 US-51, RIDGELAND, MISSISSIPPI

PROJECT:
 GOT GEAR ADDITION
 SHEET CONTENTS:
 EROSION CONTROL DETAILS