

MATCH LINE "A"

NO.	DESCRIPTION	DATE
1	EXTENDED 14" WATERMAIN TO PEAK OAKBARK ROAD. REVISED SECTION. ADDED SECTIONS K.K. & L.L.	3.1.53
2	REVISED WATERMAIN, STORM SANITARY LINES. REVISED SECTIONS, ADDED SECTIONS K.K. & L.L.	3.7.53
3	REVISED SEWING AT SOUTH WEST ENTRANCE & OUT PARCELS. ADDED SECTION M-M & N-N.	3.11.53
4	REVISED MC KEE'S BLDG. LAYOUT. SEWER, GROUND, STREET GRADES AND SEWING. REVISED MALL SANITARY. REVISED SECTION O-O. (DELETE STORM LINE FROM M-M & O-O & 11' CONC. STRUCTURES). REVISED WATERMAIN CONDS. AT INTERSECT. OF COUNTY LINE ROAD. ADDED STORM PIPE. REVISED NATIONAL SURVEY NOTE NO. 2.	4.10.53
5	COMPLETED STORM PIPE MATERIAL. PROVISIONS IN ACCORDANCE WITH SPECIFICATIONS. ADDED SANITARY AND WATER PIPE MATERIAL TO LAYOUT.	4.20.53
6	REVISED DR. HOLLIES BLDG. LAYOUT. SEWER, GROUND, STREET GRADES AND SEWING. REVISED 12" STORM LINE FROM M-M & O-O TO DR. HOLLIES BLDG. TRENCH DRAIN.	6.2.53
7	REV. MALL BLDG. UTILITY CONNECTIONS. REV. SEWING IN MALL SERVICE COATS. REV. STORM LINE FROM O-O TO 11' STORM LINE TO 12" STORM LINE AT 5.00. REV. SAN. DRAIN AT 5.00. REV. SAN. SEWER COATING SOUTH OF STA. 44+00.00.	7.1.53
8	REV. MC KEE'S WATERMAIN CONNECTIONS. REV. SMALL ISLAND. REV. LOCATION OF ST. 2+81.1. REV. COUNTY LINE ROAD. REV. ADDED OUTPARCEL ENTRY/EXIT RD.	7.22.53
9	ADDED NOTE 9. ADDED COORDINATES FOR TERMINATION OF PIPES AT MALL. ADDED PRIMARY ELECTRIC, TELEPHONE, C.A.T.V. & GAS LINES. REV. LEGEND.	8.9.53
10	REVISED PHASES BLDG. UTILITIES CONNECTIONS. REVISED COORDINATES. REVISED DR. HOLLIES UTILITIES. REVISED MC KEE'S PHASE A AREA. REVISED MALL PHASE B UTILITIES.	

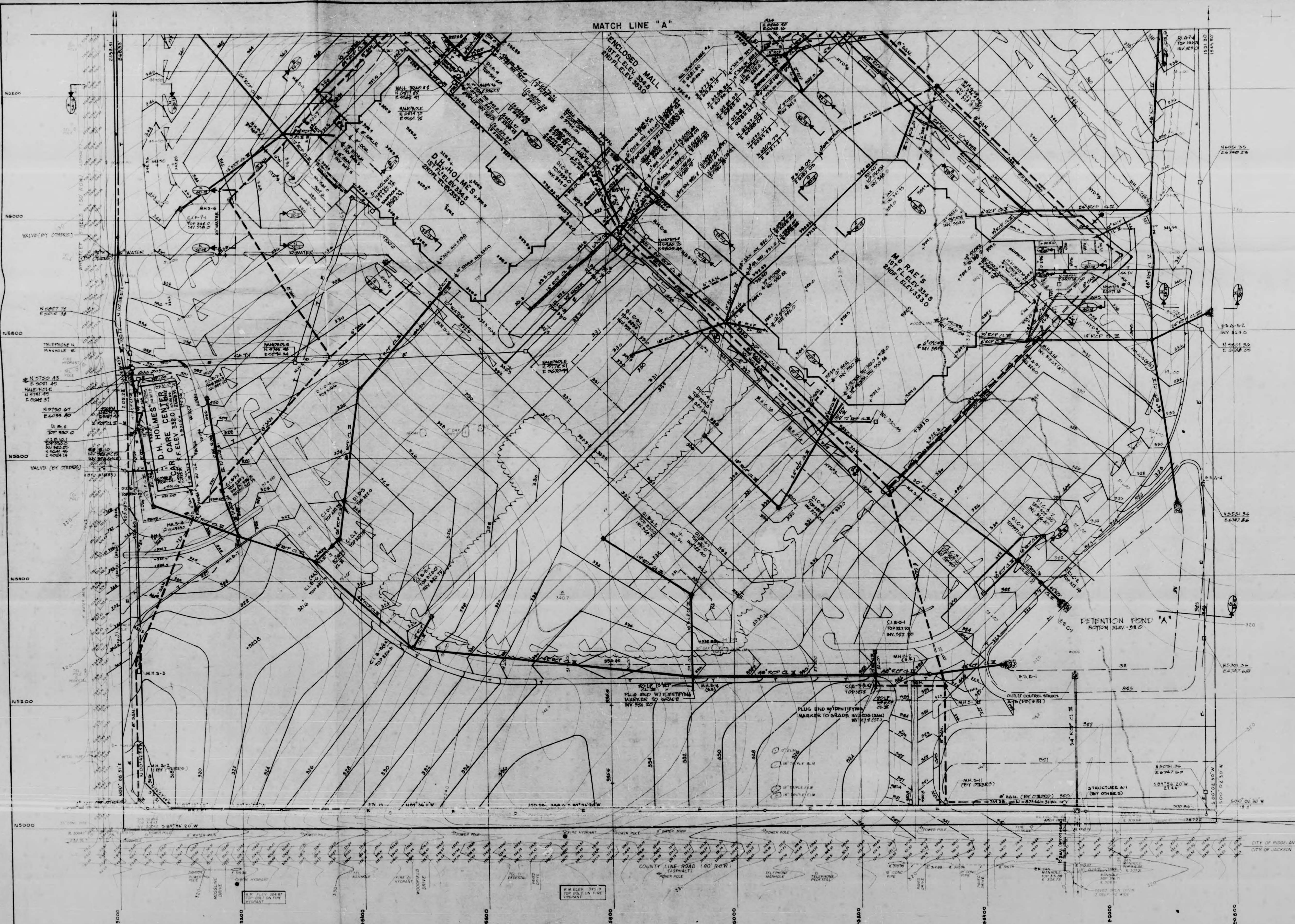

INTERIM PRINT 10-28-53

**NORTHPARK**  
RIDGLAND, MISSISSIPPI

Cable Factors Shopping Center (U.S.) Limited  
North Broadway, White Plains, New York 10601

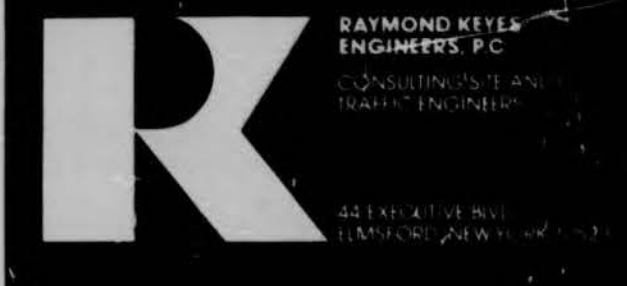

**SITE GRADING & UTILITIES PLAN**  
(SHEET 1 OF 2)

SCALE: 1" = 50'  
DATE: 2/25/53  
DRAWN BY: JAN  
CHECKED BY: HWN  
POND NO: 3165  
DRAWING NO: SD-3

LEGEND	
---	EXISTING GRADE
+ 320.0	EXISTING SPOT GRADE
---	PROPOSED FINISHED GRADE
+ 320.0	PROPOSED SPOT GRADE
○	EXISTING MANHOLE
○	PROPOSED MANHOLE (DET. NWT)
□	EXISTING W/LET
□	PROPOSED DRAIN W/LET
□	PROPOSED COMBINATION W/LET (DET. NWT)
□	PROPOSED END SECTION OF DRAIN
○	EXISTING HYDRANT
○	PROPOSED HYDRANT & GATE VALVE (DET. NWT)
---	EXISTING STORM LINE & SIZE
---	PROPOSED STORM LINE & SIZE
---	EXISTING SANITARY LINE & SIZE
---	PROPOSED SANITARY LINE & SIZE
---	EXISTING WATER LINE & SIZE
---	PROPOSED WATER LINE & SIZE
---	EXISTING GAS LINE & SIZE
---	PROPOSED GAS LINE & SIZE
---	EXISTING WATER SOURCE
---	PROPOSED DITCH OR SWALE
---	PROPOSED SWAMP
---	EXISTING UTILITY POLE
---	PROPOSED UTILITY POLE
---	PROPOSED TELEPHONE LINE
---	PROPOSED CABLE TELEVISION LINE

**Notes:**

- Existing topographical and utilities information obtained from survey entitled, "The Park, Ridgeland, Mississippi, Topographic Survey", revised 12/21/52, as prepared by Joe A. Waggoner, Brandon, Jackson, Mississippi.
- For storm and sanitary structure coordination, see Drawing SD-4.
- TEMPORARY TERMINATION OF PIPES AT BUILDING SHALL BE PLUGGED WITH A MARKER TO GRADE.

K 207

5100

APPROVED 11-22-53  
**Bill Wain**  
REGISTERED PROFESSIONAL ENGINEER  
MISSISSIPPI STATE BOARD OF REGISTERED ENGINEERS



