

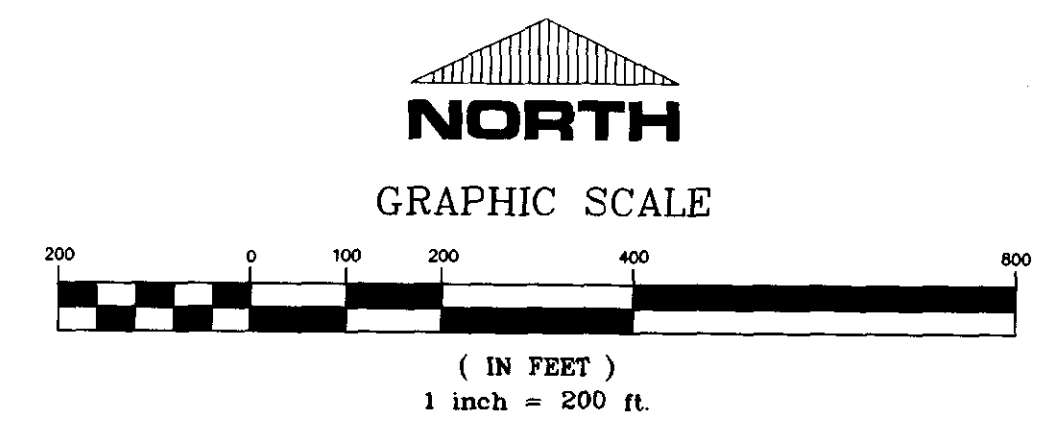

# WATER MASTER PLAN

DEVELOPMENTS OF SHADOWOOD PARTNERS  
AND LAKE HARBOUR ROAD, L.P.  
MANAGED BY  
CRESS DEVELOPMENT, INC.

SECTION 29, TOWNSHIP 7 NORTH, RANGE 2 EAST  
CITY OF RIDGELAND  
MADISON COUNTY, MISSISSIPPI

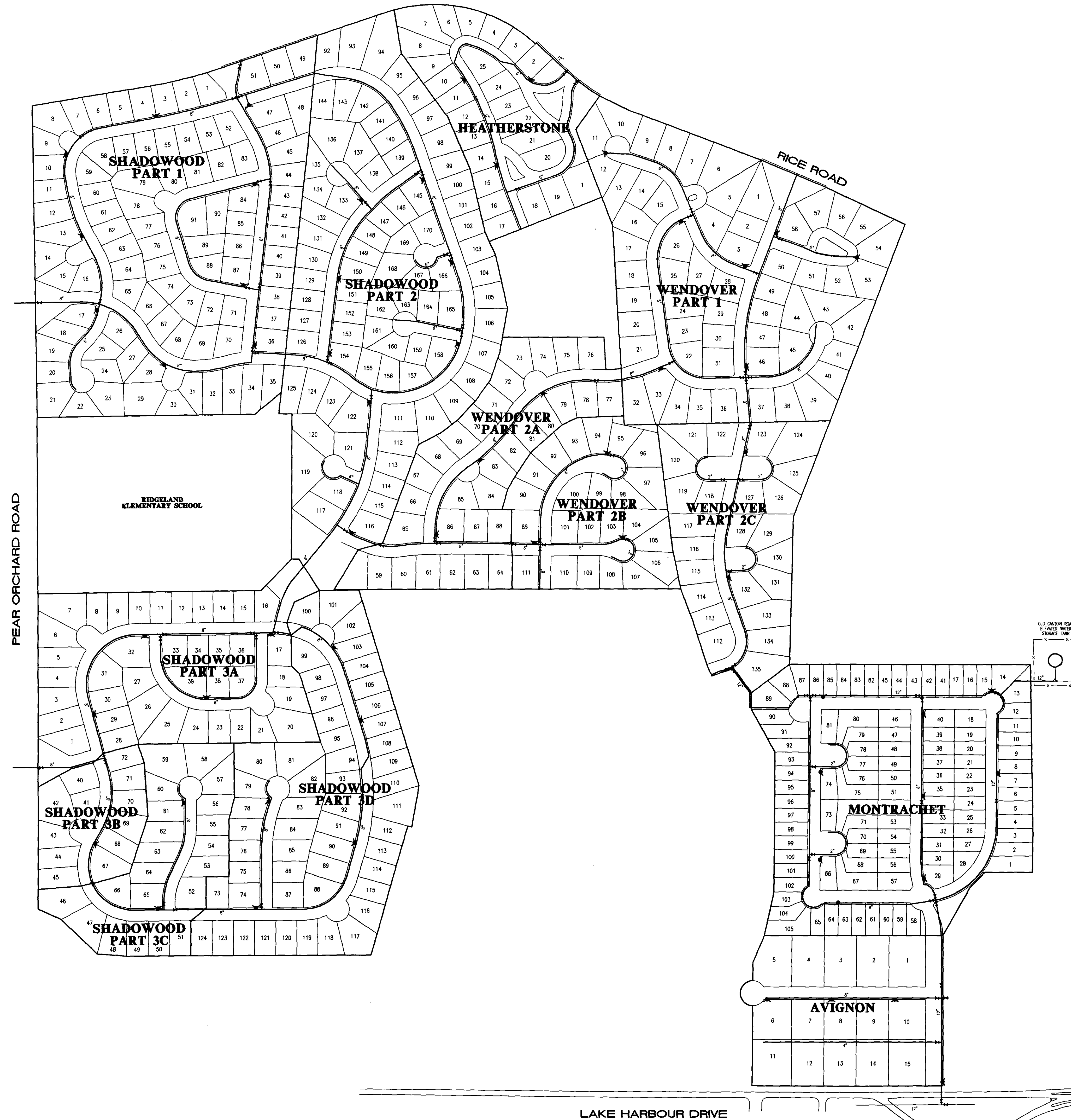
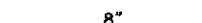

- LEGEND**
-  8" WATER MAIN SIZE
  -  GATE VALVE & BOX
  -  FIRE HYDRANT

LAKE HARBOUR DRIVE

PWP-01930

Prepared By:  
**STERLING**  
Consultants  
INC.